



AGRICULTURAL SPARE PARTS



2 Presentation of the Company

16 Blades Discs / Discs for Ploughs

30 Discs for Seeders

42 Rapid Tillage

46 Rapid Tillage / Subsoiler / Blades

52 Spring Tines and Sweep

70 Blades for the Feed Mixers

82 Ploughs Parts

COMPANY PROFILE

O.F.A.S. works in the sector of the metal and mechanical industry, that produces spare parts, specialising in those used in agricultural machinery, in construction firms and also in gardening.

The company also accepts orders for customized articles

In 1950, in a small workshop with hydraulic- power- driven machinery, the Favero family began to work with iron producing tips for chisels and picks, and blades for spades.

From a family-run workshop O.F.A.S. then became a small limited company called



“Officine Riunite Favero S.a.s”, expanding production to include gardening tools. At the end of the 1960s the company moved to its present site and developed a new range of products for agriculture and for spare parts for agricultural machinery. Since then the Company has been registered as O.F.A.S. S.p.a. (Officine Favero Attrezzi Stampati).

To meet the ever-increasing demand for its products from clients, both at home and abroad, O.F.A.S. has expanded and developed its production departments with the acquisition of the most up-to-date technological machinery. All machinery complies with current safety and environmental regulations.

Past and present mingle in order to offer a valuable, high-quality product, each step in the production of which has been carefully followed with attention, expertise and efficiency.

A well-trained staff, with the most up-to-date equipments, is always ready and willing to meet clients' demands and satisfy their requests.

O.F.A.S. S.p.a has one outstanding feature and that is flexibility, thanks to which the Company can cope with the clients' demands and solve their problems with a smile, so, thanks to the high quality of the material added to the expertise of the staff, the Company can offer a product that is not only special but also competitive on the market.























O.F.A.S. AND QUALITY



O.F.A.S. uses only raw materials coming from top class European steelworks that have been selected over the years. With today's constant technological progress, the choice of raw material for a component is never a foregone conclusion, and having the best is a must that involves the technologies of both production and design.

Boron steel in particular is used in the production of items that have to stand up to wear and tear.

The applications are many and various depending on the characteristics of the boron.

After heat treatment, in fact, boron is characterised by an elevated thermal resistance, but with a limited increase in manufacturing costs.

O.F.A.S. moreover, uses steel with a high grade of carbonium, and also Triplex steel that is commonly used in ploughs.

Boron steel is the ideal solution for a high

quality product at a relatively low cost.

O.F.A.S. applies durable coatings and facings with tungsten/cobalt linings.

These applications are micro-granular which when deposited with HVOF technology render the surface resistant to wear and tear, to corrosion and to chemical agents.

The degree of hardness that can be achieved is extremely high.



Blades
Discs

Discs for
Ploughs

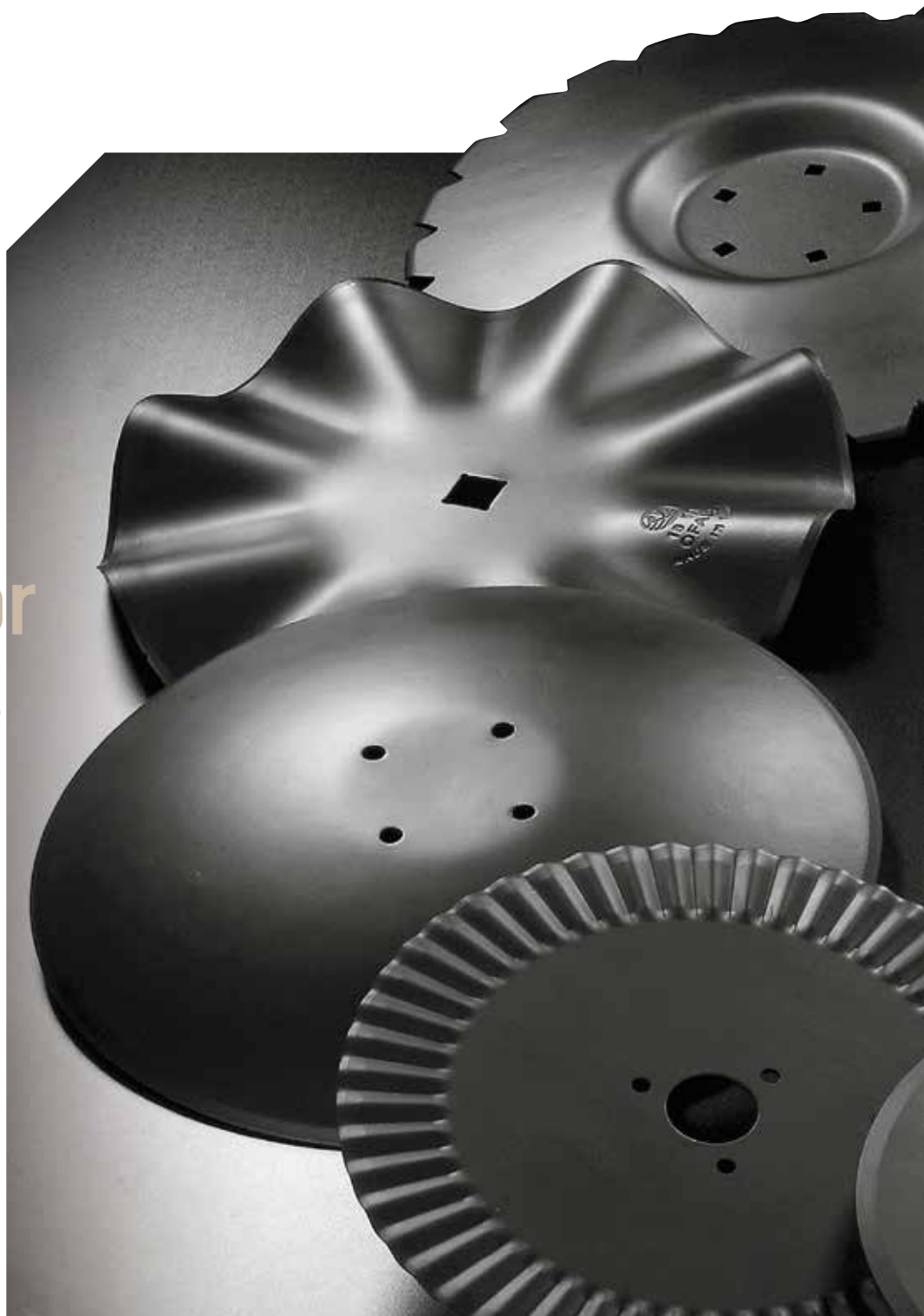



BLADE DISCS

CONCAVE DISC

DIAMETER D		THICKNESS		PLAIN DISC Weight		TOOTHED DISC Weight	
mm	inch	mm	inch	kg	lb	kg	lb
250	10"	2,5	6/64"	1,15	2,5	-	-
280	11"	2,5	6/64"	1,30	2,9	-	-
305	12"	2,5	6/64"	1,40	3,1	-	-
310	12"	4,5	11/64"	2,80	6,2	-	-
325	13"	2,5	6/64"	1,60	3,5	-	-
330	13"	2,5	6/64"	1,65	3,6	-	-
350	14"	3	8/64"	2,20	4,9	-	-
360	14"	4,5	11/64"	3,70	8,2	-	-
410	16"	3,2	8/64"	3,50	7,7	3,00	6,6
410	16"	6	15/64"	6,10	13,4	-	-
460	18"	3,2	8/64"	4,40	9,7	3,60	7,9
460	18"	3,5	9/64"	4,80	10,6	3,90	8,6
460	18"	6	15/64"	6,80	15,0	-	-
510	20"	3,5	9/64"	5,80	12,8	5,20	11,5
510	20"	4	10/64"	6,70	14,8	6,00	13,2
510	20"	4,5	11/64"	7,30	16,1	6,50	14,3
510	20"	5	13/64"	8,40	18,5	7,70	17,0
510	20"	6	15/64"	9,60	21,2	8,60	18,2
530	21"	4	10/64"	7,50	16,5	6,70	14,8
530	21"	6	15/64"	10,50	23,1	9,70	21,4
560	22"	4	10/64"	8,20	17,64	7,20	15,63
560	22"	4,5	11/64"	9,00	19,8	7,90	17,4
560	22"	5	13/64"	9,90	21,48	8,80	19,1
560	22"	6	15/64"	11,60	25,60	10,30	22,7
610	24"	5	13/64"	11,60	25,60	10,50	23,1
610	24"	6	15/64"	14,10	31,1	12,70	28,0
610	24"	7	18/64"	16,45	36,27	14,84	32,72
610	24"	8	20/64"	18,80	41,45	17,00	37,48
660	26"	5	15/64"	13,20	29,05	12,20	26,84
660	26"	6	15/64"	17,20	37,9	15,50	34,2
660	26"	7	18/64"	20,10	44,3	18,10	39,9
660	26"	8	20/64"	23,60	52,0	20,70	45,6
710	28"	6	15/64"	20,03	44,2	18,50	40,8
710	28"	7	18/64"	23,00	50,71	21,50	47,4
710	28"	8	20/64"	26,50	58,42	24,50	54,01
710	28"	10	25/64"	32,7	52,14	29,8	65,56
760	30"	8	20/64"	29,10	64,2	26,80	59,1
760	30"	10	25/64"	36,20	79,8	33,50	73,9
810	32"	8	20/64"	30	65	28	62
810	32"	10	25/64"	43	95	40	88
910	36"	12	30/64"	68	150	60	132
960	38"	12	30/64"	77	169	70	154
1016	40"	12	30/64"	82	180	77	169

PLAIN DISC



NOTCHED DISC



DIAMETER AND RADIUS - CONCAVE DISC

DIAMETER D		C	STAMP CODE 003		STAMP CODE 042		STAMP CODE 002		STAMP CODE 014		STAMP CODE 004		STAMP CODE 005	
		R	370	14 6/16	508	20 9/16	525	20 11/16	540	21 4/16	570	22 7/16	585	23 1/16
mm	inch		mm	inch	mm	inch	mm	inch	mm	inch	mm	inch	mm	inch
250	0"		-	-	16	5/8	-	-	-	-	14	9/16	-	-
280	11"		-	-	20	25/32	-	-	-	-	17	21/32	-	-
305	12"		-	-	23	29/32	-	-	-	-	20	25/32	-	-
310	12 3/16		35	1 3/8	24	15/16	25	31/32	-	-	22	7/8	21	13/16
325	12 13/16		38	1 1/2	26	1 1/32	26	1 1/32	-	-	23	29/32	23	29/32
330	13"		39	1 17/32	27	1 1/16	27	1 1/16	-	-	24	15/16	24	15/16
350	14"		44	1 23/32	31	1 7/32	30	1 3/16	-	-	28	1 3/32	27	1 1/16
360	14"		47	1 27/32	33	1 5/16	33	1 5/16	-	-	31	1 7/32	30	1 3/16
410	16"		60	2 3/8	43	1 11/16	42	1 21/32	41	1 5/8	39	1 9/16	38	1 1/2
460	18"		74	2 29/32	55	2 5/32	53	2 3/32	49	1 15/16	49	1 15/16	48	1 7/8
510	20"		-	-	68	2 11/16	66	2 19/32	63	2 15/32	61	2 13/32	59	2 5/16
530	20 7/8		-	-	-	-	72	2 27/32	70	2 3/4	65	2 9/16	64	2 17/32
560	22"		-	-	-	-	81	3 7/32	76	2 31/32	72	2 27/32	71	2 25/32
610	24"		-	-	-	-	98	3 27/32	91	3 19/32	-	-	84	3 5/16
660	26"		-	-	-	-	-	-	108	4 1/4	-	-	100	3 15/16
710	28"		-	-	-	-	-	-	-	-	-	-	120	4 23/32
760	30"		-	-	-	-	-	-	-	-	-	-	-	-
810	32"		-	-	-	-	-	-	-	-	-	-	-	-
910	36"		-	-	-	-	-	-	-	-	-	-	-	-

DIAMETER D		C	STAMP CODE 006		STAMP CODE 075		STAMP CODE 007		STAMP CODE 054		STAMP CODE 060		STAMP CODE 074	
		R	610	24"	645	25 25/74	670	26 6/16	695	27 3/8	725	28 1/2	740	29 1/8
mm	inch		mm	inch	mm	inch	mm	inch	mm	inch	mm	inch	mm	inch
250	0"		-	-	-	-	-	-	-	-	-	-	-	-
280	11"		-	-	-	-	-	-	-	-	-	-	-	-
305	12"		-	-	-	-	17	0 21/32	-	-	16	0 5/8	-	-
310	12 3/16		-	-	-	-	-	-	-	-	-	-	-	-
325	12 13/16		-	-	-	-	-	-	-	-	-	-	-	-
330	13"		-	-	-	-	21	0 13/16	-	-	19	0 3/4	-	-
350	14"		-	-	-	-	-	-	-	-	-	-	-	-
360	14"		-	-	-	-	25	0 31/32	-	-	23	0 29/32	-	-
410	16"		37	1 15/32	-	-	32	1 1/4	-	-	30	1 3/16	-	-
460	18"		46	1 13/16	-	-	41	1 5/8	-	-	37	1 15/32	-	-
510	20"		57	2 1/4	52	2 3/64	50	1 31/32	-	-	46	1 3/16	45	1 25/32
530	20 7/8		61	2 13/32	-	-	-	-	-	-	-	-	-	-
560	22"		68	2 11/16	63	2 31/64	61	2 13/32	-	-	-	-	55	2 11/64
610	24"		81	3 3/16	76	3"	73	2 7/8	71	2 25/32	-	-	66	2 19/32
660	26"		97	3 13/16	91	3 19/32	87	3 7/16	83	3 9/32	-	-	78	3 5/64
710	28"		112	4 13/32	106	4 11/64	102	4 1/32	98	3 27/32	-	-	91	3 19/32
760	30"		-	-	123	4 27/32	118	5 41/64	113	4 7/16	-	-	105	4 9/64
810	32"		-	-	142	5 19/32	136	5 23/64	130	5 1/8	-	-	121	4 49/64
910	36"		-	-	-	-	-	-	-	-	-	-	-	-

DIAMETER D		C	STAMP CODE 056		STAMP CODE 057		STAMP CODE 059		STAMP CODE 040	
		R	810	32"	920	36"	993	39"	1085	42 11/16
mm	inch		mm	inch	mm	inch	mm	inch	mm	inch
250	0"		-	-	-	-	-	-	-	-
280	11"		-	-	-	-	-	-	-	-
305	12"		-	-	-	-	-	-	-	-
310	12 3/16		-	-	-	-	-	-	-	-
325	12 13/16		-	-	-	-	-	-	-	-
330	13"		-	-	-	-	-	-	-	-
350	14"		-	-	-	-	-	-	-	-
360	14"		-	-	-	-	-	-	-	-
410	16"		-	-	-	-	-	-	-	-
460	18"		-	-	-	-	-	-	24	15/16
510	20"		-	-	-	-	-	-	30	1 3/16
530	20 7/8		-	-	-	-	-	-	33	1 5/16
560	22"		-	-	-	-	-	-	36	1 13/32
610	24"		-	-	-	-	48	1 7/8	43	1 11/16
660	26"		68	2 11/16	61	2 13/32	56	2 7/32	51	2"
710	28"		79	3 1/8	71	2 25/32	66	2 19/32	59	2 5/16
760	30"		91	3 19/32	82	3 7/32	76	2 31/32	68	2 11/16
810	32"		104	4 3/32	94	3 11/16	86	3 3/8	-	-
910	36"		134	5 9/32	120	4 23/32	-	-	-	-

CURVED DISC



BLADE DISCS

DIAMETER AND RADIUS - DISC WITH FLAT CENTER

DIAMETER D		C	STAMP CODE 009		STAMP CODE 026		
		P	100 mm		130 mm		
		R	570 mm		610 mm		
mm	inch	mm	inch	mm	inch	mm	inch
410	16"	41	1" 10/16"	-	-	-	-
460	18"	49	1" 15/16"	-	-	-	-
510	20"	59	2" 5/16"	-	-	-	-
530	20" 7/8	62	2" 7/16"	-	-	-	-
560	22"	69	2" 11/16"	-	-	-	-
610	24"	-	-	84	3" 5/16"	-	-
660	26"	-	-	98	3" 14/16"	-	-
710	28"	-	-	112	4" 7/16"	-	-
760	30"	-	-	124	4" 14/16"	-	-

DISC WITH FLAT

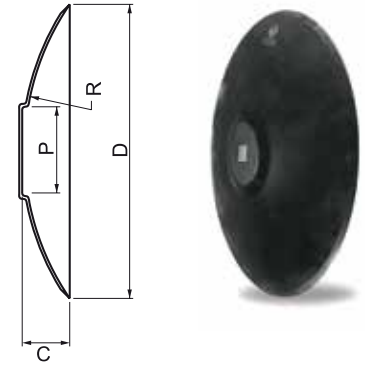

DIAMETER AND RADIUS - DISC WITH FLAT CENTER

DIAMETER D		C	STAMP CODE 009		STAMP CODE 026		
		P	100 mm		130 mm		
		R	570 mm		610 mm		
mm	inch	mm	inch	mm	inch	mm	inch
250	10"	13	8/16"	-	-	-	-
280	11"	16	10/16"	-	-	-	-
305	12"	19	12/16"	-	-	-	-
310	12" 3/16	21	13/16"	-	-	-	-
325	12" 13/16	22	14/16"	-	-	-	-
330	13"	23	14/16"	20	25-32"	-	-
350	14"	26	1"	23	14/16"	-	-
360	14"	29	1" 2/16"	24	15/16"	-	-
410	16"	37	1" 7/16"	33	1" 19/16"	-	-
460	18"	47	1" 14/16"	41	1" 1/2"	-	-
510	20"	-	-	52	2" 1/16"	-	-
530	20" 7/8	-	-	58	2" 9/32"	-	-
560	22"	-	-	65	2" 9/16"	-	-
610	24"	-	-	-	-	-	-
660	26"	-	-	-	-	-	-
710	28"	-	-	-	-	-	-
760	30"	-	-	-	-	-	-

DISC TRUNK CONE

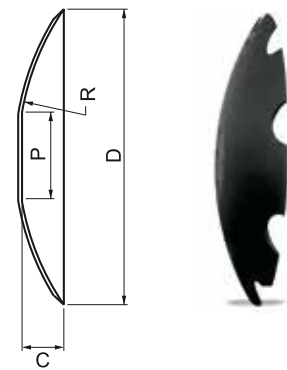

DIAMETER D		C	STAMP CODE 008		STAMP CODE 033		STAMP CODE 035		STAMP CODE 045		STAMP CODE 052		
		P	155 mm		170 mm		175 mm		130 mm		160 mm		
		R	585 mm		585 mm		770 mm		508 mm		615 mm		
mm	inch	mm	inch	mm	inch	mm	inch	mm	inch	mm	inch	mm	inch
250	10"	-	-	-	-	-	-	-	-	-	-	-	-
280	11"	-	-	-	-	-	-	-	-	-	-	-	-
305	12"	-	-	-	-	-	-	-	-	-	-	-	-
310	12" 3/16	20	25/32"	-	-	-	-	-	-	-	-	-	-
325	12" 13/16	21	13/16"	-	-	-	-	-	-	-	-	-	-
330	13"	22	14/16"	-	-	-	-	-	-	-	-	-	-
350	14"	25	1"	-	-	-	-	-	-	-	-	-	-
360	14"	28	1" 2/16"	-	-	-	-	-	-	-	-	-	-
410	16"	36	1" 7/16"	-	-	-	-	38	1" 32/64	29	1" 9/64	-	-
460	18"	46	1" 13/16"	46	1" 13/16"	28	1" 3/32"	50	1" 62/64	39	1" 34/64	-	-
510	20"	57	2" 4/16"	57	2" 4/16"	36	1" 13/32"	64	2" 33/64	50	1" 62/64	-	-
530	20" 7/8	62	2" 7/16"	-	-	-	-	-	-	-	-	-	-
560	22"	68	2" 11/16"	68	2" 11/16"	44	1" 23/32"	-	-	-	-	-	-
610	24"	81	3" 3/16"	80	3" 3/16"	56	2" 7/32"	-	-	-	-	-	-
660	26"	97	3" 13/16"	97	3" 13/16"	-	-	-	-	-	-	-	-
710	28"	-	-	-	-	-	-	-	-	-	-	-	-
760	30"	-	-	-	-	-	-	-	-	-	-	-	-

DIAMETER AND RADIUS - BULLDOG DISC

DIAMETER D		STAMP CODE 073			
		670 mm			
mm	inch	mm	inch		
-	-	-	-		
-	-	-	-		
-	-	-	-		
560	22"	61	2" 13/32		
610	24"	73	2" 7/18		
660	26"	87	3" 7/16		
710	28"	102	4" 1/32		
-	-	-	-		

BULLDOG

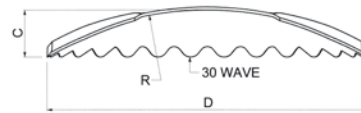
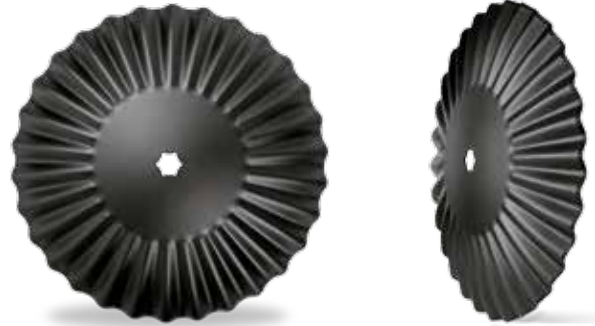

SPECIAL DISC

DIAMETER D		STAMP CODE 046							
		A		B		C		THICKNESS	
mm	inch	mm	inch	mm	inch	mm	inch	mm	inch
510	20"	234	9" 7/32	160	6" 19/64	28	1" 7/64	4	5/32"
560	22"	234	9" 7/32	160	6" 19/64	33	1" 19/64	4	5/32"

SPECIAL DISC

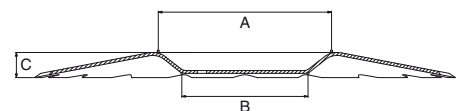
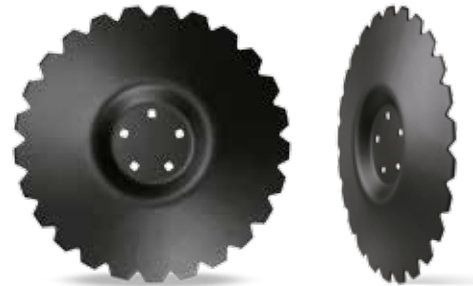

SPECIAL DISC

DIAMETER D		STAMP CODE 047					
		900 mm					
		A		B		THICKNESS	
mm	inch	mm	inch	mm	inch	mm	inch
620	24"	79	3" 7/64	116	4" 36/64	6	15/64"

SPECIAL DISC

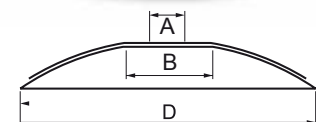

BLADE DISCS

CONIC DISC

DIAMETER D		STAMP CODE 020		020/1
		P		200 mm
mm		inch		mm
510	20"	60	2" 23/64	-
560	22"	73	2" 7/8	-
610	24"	81	3" 3/16	-
660	26"	96	3" 25/32	-
710	28"	108	4" 1/4	-
760	30"	123	4" 27/32	-

DISC TRUNK CONE

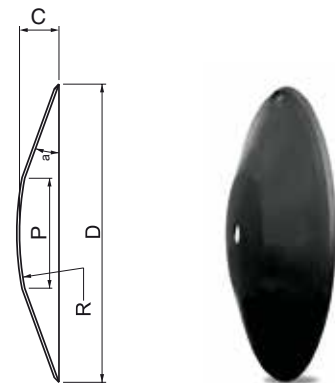

WAVED DISC WITH FLAT CENTER

DIAMETER D		STAMP CODE 012								
		THICKNESS		WEIGHT		FLAT IN center P		N. Wave	HEIGHT Wave A	
mm	inch	mm	inch	kg	lb	mm	inch		mm	inch
470	18" 8/16	4	3/16	5,50	12,1	170	6" 11/16	8	45	1" 12/16
520	20" 8/16	5	3/16	8,40	18,5	170	6" 11/16	8	60	2" 6/16
520	20" 8/16	6	4/16	9,60	21,2	170	6" 11/16	8	60	2" 6/16
580	22" 13/16	5	3/16	10,00	22	220	8" 11/16	8	63	2" 8/16
580	22" 13/16	6	4/16	11,60	25,6	220	8" 11/16	8	63	2" 8/16
580	22" 13/16	7	4/16	13,50	29,8	220	8" 11/16	8	63	2" 8/16
630	24"	6	4/16	14,1	31,1	220	8" 11/16	8	63	2" 8/16

WAVED DISC

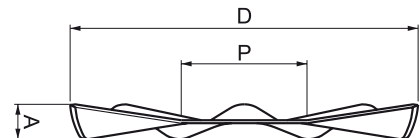
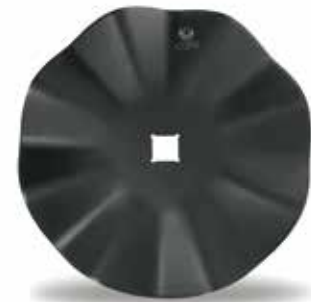

STAR DISC

DIAMETER D		STAMP CODE 021				
		THICKNESS		N. Fold	INCLINATION	WEIGHT
mm	inch	mm	inch			kg
520	20" 8/16	5	3/16"	6	27°	5,36

STAR DISC DX

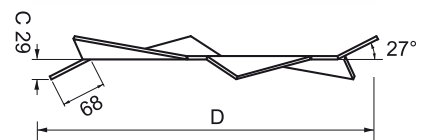
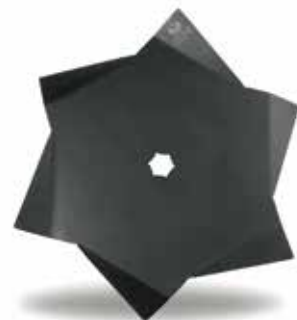

SPECIAL DISC

DIAMETER D		STAMP CODE					
		610 mm					
		THICKNESS		B		WEIGHT	
mm	inch	mm	inch	mm	inch	kg	lb
610	24"	6	15/64"	81	3" 3/16	12,35	27,23
650	26"	6	15/64"	97	3" 13/16	15,00	33,06
710	28"	8	5/16"	112	4" 13/32	17,78	39,20
760	30"	8	5/16"	130	5" 1/8	20,10	44,09

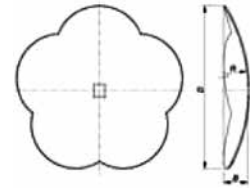
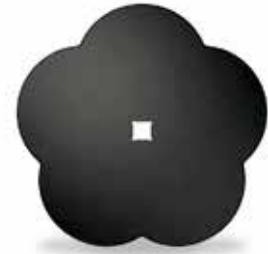

SPECIAL DISC

DIAMETER D		STAMP CODE				NOTE
		695 mm				
		THICKNESS		WEIGHT		
mm	inch	mm	inch	kg	lb	
710	28"	8	5/16"	-	-	right and left
710	28"	10	25/64"	-	-	right and left
760	30"	8	5/16"	-	-	right and left
760	30"	10	25/64"	-	-	right and left
810	32"	8	5/16"	-	-	right and left
810	32"	10	25/64"	-	-	right and left



PACKER RING

PACKER RING DISC 019

HARROW DISC

DIAMETER D		c	STAMP CODE 019				
			A LARGE		THICKNESS		WEIGHT
mm	inch		mm	inch	mm	inch	kg
600	23" 10/16		80	3" 2/16	4+4	5/32	4,70 x 2
700	27" 9/16		80	3" 2/16	4+4	5/32	4,70 x 2

Single disc is provided

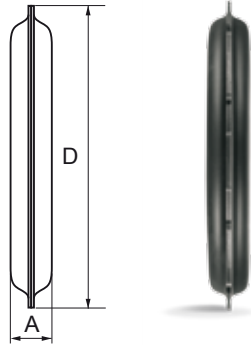

PACKER RING

DIAMETER D		c	STAMP CODE 019				
			A LARGE		HOLE		WEIGHT
mm	inch		mm	inch	mm	inch	kg
320	12" 19/32		85	3" 11/32	41	1" 9/64	9,00



STAR HARROWS

STAR HARROW

LENGHT A	HEIGHT B	THICKNESS		HOLE DISTANCE	WEIGHT	Ø/HOLES
mm	mm	mm	inch	mm	kg	mm
400	60	8	20/64"	105	1,45	13,5

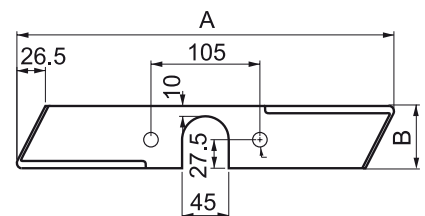
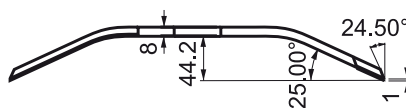

BLADE DISCS

FLAT DISC

DIAMETER D		THICKNESS		Weight	
mm	inch	mm	inch	kg	lb
406	16"	3	88/64"	2,85	6,28
406	16"	3,5	9/64"	3,34	7,36
406	16"	4	10/64"	3,83	8,44
406	16"	5	13/64"	4,78	10,54
433	17"	4	10/64"	4,25	9,37
433	17"	4,5	11/64"	4,79	10,56
450	17,5"	4	10/64"	4,40	9,70
457	18"	3,5	9/64"	4,08	9,00
457	18"	4	10/64"	4,68	10,32
457	18"	4,5	11/64"	5,27	11,62
457	18"	5	13/64"	5,84	12,87
457	18"	6	15/64"	6,97	15,37
457	18"	7	18/64"	8,09	17,84
470	19"	5	13/64"	5,90	13,01
508	20"	3,5	9/64"	5,23	11,53
508	20"	4	10/64"	5,97	13,16
508	20"	4,5	11/64"	6,70	14,77
508	20"	5	13/64"	7,43	16,38
508	20"	6	15/64"	8,84	19,49
582	22"	4	10/64"	7,89	17,40
582	22"	4,5	11/64"	8,86	19,53
582	22"	5	13/64"	9,82	21,65
582	22"	6	15/64"	11,70	25,79
610	24"	4,5	11/64"	9,75	21,49
610	24"	5	13/64"	10,81	23,83
610	24"	6	15/64"	12,89	28,42
635	25"	5	13/64"	11,58	25,53
635	25"	6	15/64"	13,99	30,84
660	26"	6	15/64"	16,00	35,27
660	26"	8	20/64"	21,50	47,40
711	28"	6	15/64"	19,50	42,99
711	28"	8	20/64"	26,40	58,20
762	30"	8	20/64"	31,00	68,34
762	30"	10	25/64"	38,00	83,78
813	32"	8	20/64"	33,50	73,85
813	32"	10	25/64"	41,50	91,50
914	36"	12	30/64"	65,00	143,30
960	38"	12	30/64"	-	-
1016	40"	12	30/64"	-	-



Good cut and penetration. Minimum tilling action.

WAVED DISC ONDULATION

DIAMETER D		THICKNESS	
mm	inch	mm	inch
460	18"	4	10/64"
460	18"	5	13/64"
510	20"	4	10/64"
510	20"	5	13/64"
570	22"	5	13/64"
610	24"	5	13/64"

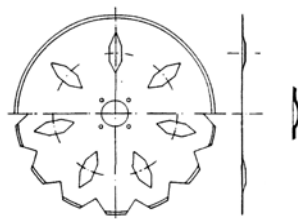

FLAT DISC NOTCHED

DIAMETER D		THICKNESS		Weight	
mm	inch	mm	inch	kg	lb
406	16"	3	88/64"	2,85	6,28
406	16"	3,5	9/64"	3,34	7,36
406	16"	4	10/64"	3,83	8,44
406	16"	5	13/64"	4,78	10,54
433	17"	4	10/64"	4,25	9,37
433	17"	4,5	11/64"	4,79	10,56
450	17,5"	4	10/64"	4,40	9,70
457	18"	3,5	9/64"	4,08	9,00
457	18"	4	10/64"	4,68	10,32
457	18"	4,5	11/64"	5,27	11,62
457	18"	5	13/64"	5,84	12,87
457	18"	6	15/64"	6,97	15,37
457	18"	7	18/64"	8,09	17,84
470	19"	5	13/64"	5,90	13,01
508	20"	3,5	9/64"	5,23	11,53
508	20"	4	10/64"	5,97	13,16
508	20"	4,5	11/64"	6,70	14,77
508	20"	5	13/64"	7,43	16,38
508	20"	6	15/64"	8,84	19,49
582	22"	4	10/64"	7,89	17,40
582	22"	4,5	11/64"	8,86	19,53
582	22"	5	13/64"	9,82	21,65
582	22"	6	15/64"	11,70	25,79
610	24"	4,5	11/64"	9,75	21,49
610	24"	5	13/64"	10,81	23,83
610	24"	6	15/64"	12,89	28,42
635	25"	5	13/64"	11,58	25,53
635	25"	6	15/64"	13,99	30,84
660	26"	6	15/64"	16,00	35,27
660	26"	8	20/64"	21,50	47,40
711	28"	6	15/64"	19,50	42,99
711	28"	8	20/64"	26,40	58,20
762	30"	8	20/64"	31,00	68,34
762	30"	10	25/64"	38,00	83,78
813	32"	8	20/64"	33,50	73,85
813	32"	10	25/64"	41,50	91,50
914	36"	12	30/64"	65,00	143,30
960	38"	12	30/64"	-	-
1016	40"	12	30/64"	-	-



Good cut and penetration with high residues. Minimum tilling action.

WAVED DISC 50 ONDULATION

c STAMP CODE 036					
DIAMETER D		THICKNESS			
mm	inch	mm	inch		
430	17"	4	10/64"		
460	18"	4	10/64"		
460	18"	5	13/64"		
510	20"	4	10/64"		
510	20"	5	13/64"		



BLADE DISC

CENTER HOLES

HOLE Cod.	DIAMETER mm														
	T	Q	E	D	B	25	30	35	40	45	50	55	60	65	70
T	25	30	35	40	45	50	55	60	65	70	-	-	-	-	-
Q	23	26	29	31	33	41	46	51	56	-	-	-	-	-	-
E	37	41	67	88	90	92	98	-	-	-	-	-	-	-	-
D	30/41	37/41	-	-	-	-	-	-	-	-	-	-	-	-	-
B	Q35T39	Q41T46	Q27T29	-	-	-	-	-	-	-	-	-	-	-	-

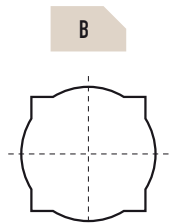
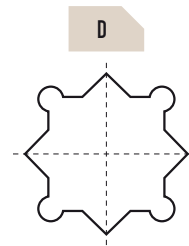
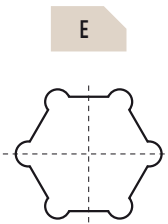
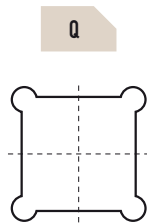
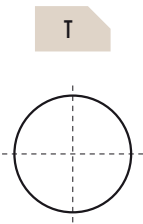

DISC NOTCHES _ Standard

DIAMETER D		Number of notches	A	B
mm	inch			
410	16"	8	88	35
460	18"	9	88	35
510	20"	10	88	35
560	22"	10	86	35
610	24"	11	90	45
660	26"	12	90	45
710	28"	13	90	45
760	30"	13	90	45
810	32"	14	90	40
860	36"	15	90	40
960	38"	16	90	40
1016	40"	17	90	40

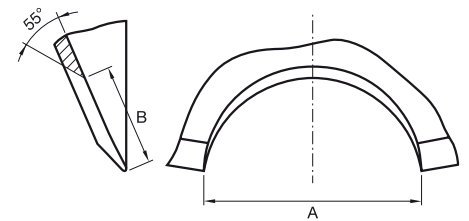

DISC NOTCHES _ Special large notches

DIAMETER D		Number of notches	A	B
mm	inch			
610	24"	8	110	55
660	26"	8	110	55
710	28"	10	110	55
760	30"	10	110	55
810	32"	12	110	55
910	36"	12	110	55

Only for exterior edge

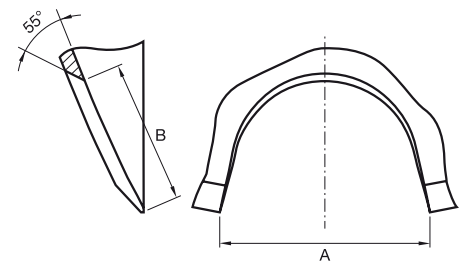

DISC NOTCHES _ Mini-notches

DIAMETER D		Number of notches	A	B
mm	inch			
410	16"	20	20	10
460	18"	20	20	10
510	20"	20	20	10

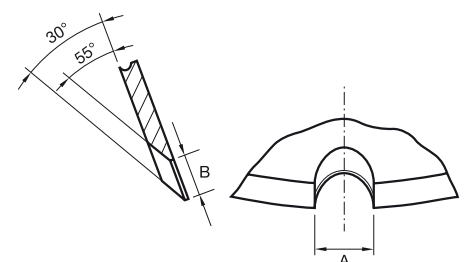

CONCAVE DISC BEVELS _ Outside-inside edge off bevel

THICKNESS mm	L mm	C mm	D mm
2,5	6	0	1,4
3	7	0	1,7
3,5	8	0	2
4	10	0	2,2
4,5	11	0	2,5
5	12	0	2,8

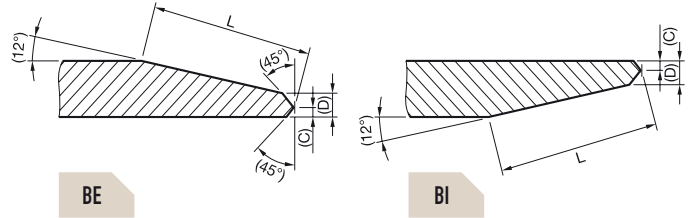

CONCAVE DISC BEVELS _ Outside-inside bevel RM

THICKNESS mm	L mm	I mm	Angle	C mm	D mm
4	22	6	0°	1	2,8
4,5	23	6	0°	1,1	3,2
5	24	6	0°	1,2	3,5
6	25	6	0°	1,3	4,3
7	26,5	10	45°	1,5	5
8	28	10	45°	2,25	5,7
10	32	10	45°	2,5	7
12	36	10	45°	4,25	8,5

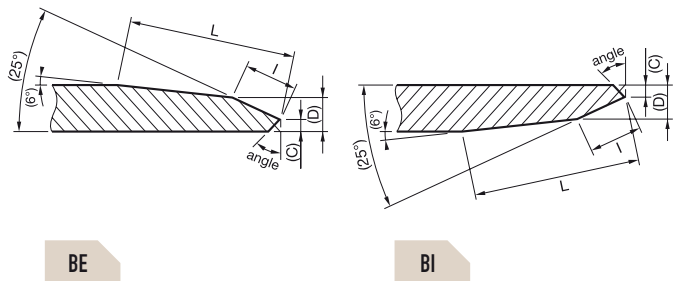

CONCAVE DISC BEVELS _ Outside bevel 30°

THICKNESS mm	L mm	H mm
3	3,5	0,8
3,5	4,5	0,8
4	5	1
4,5	6	1
5	7	1
6	8,5	1

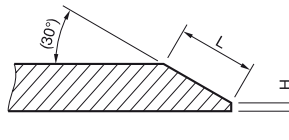

Discs for Seeders





DISCS FOR SEEDERS

DISC ASSEMBLIES



INLINE
OPENERS



OFFSET
OPENERS



INSIDE
BEVEL



OUTSIDE
BEVEL



DOUBLE
BEVEL

FLAT DISC WITH HUB

DIAMETER D		THICKNESS		Weight	
mm	inch	mm	inch	kg	lb
305	12"	2,5	6/64"	1,80	3,97
333	13"	3	8/64"	2,50	5,51
345	13,5"	3	8/64"	2,70	5,95
351	14"	3,5	9/64"	2,83	6,24
381	15"	3,5	9/64"	3,20	7,05
406	16"	4	10/64"	5,53	9,99
433	17"	4	10/64"	4,95	10,91



FLAT DISC WITH HUB

DIAMETER D		THICKNESS		Weight	
mm	inch	mm	inch	kg	lb
305	12"	2,5	6/64"	1,74	3,84
333	13"	3	8/64"	2,20	4,85
345	13,5"	3	8/64"	2,39	5,27
351	14"	3,5	9/64"	2,89	6,37
381	15"	3,5	9/64"	3,26	7,19
406	16"	4	10/64"	4,22	9,30
433	17"	4	10/64"	4,64	10,23



FLAT DISC WITH HUB

DIAMETER D		THICKNESS		Weight	
mm	inch	mm	inch	kg	lb
305	12"	2,5	6/64"	1,60	3,53
333	13"	3	8/64"	2,30	5,07
345	13,5"	3	8/64"	2,50	5,51
351	14"	3,5	9/64"	2,63	5,80
381	15"	3,5	9/64"	3,10	6,61
406	16"	4	10/64"	4,33	9,55
433	17"	4	10/64"	4,75	10,47



DISC HUB

HUB Cod.	Weight	
	kg	lb
CM0000004	0,70	1,54



HUB Cod.	Weight	
	kg	lb
CM0000005	0,50	1,10



HUB Cod.	Weight	
	kg	lb
CM0000006	0,39	0,86



DISCS FOR SEEDERS

FLAT DISC

DIAMETER D		THICKNESS		Weight	
mm	inch	mm	inch	kg	lb
255	10"	2,5	6/64"	0,92	2,03
255	10"	3,5	9/64"	1,22	2,69
282	11"	3	8/64"	1,35	2,98
305	12"	2	5/64"	1,08	2,38
305	12"	2,5	6/64"	1,35	2,98
305	12"	3	8/64"	1,78	3,92
305	12"	4	10/64"	2,00	4,41
333	13"	2,5	6/64"	1,62	3,57
333	13"	3	8/64"	1,81	3,99
333	13"	4	10/64"	2,46	5,42
343	13,5"	3	8/64"	2,00	4,41
343	13,5"	4	10/64"	2,70	5,95
351	14"	3	88/64"	2,13	4,69
351	14"	3,5	9/64"	2,50	5,51
351	14"	4	10/64"	2,86	6,30
351	14"	5	13/64"	3,56	7,85
381	15"	3	88/64"	2,50	5,51
381	15"	3,5	9/64"	2,87	6,33
381	15"	4	10/64"	3,28	7,23
381	15"	5	13/64"	4,15	9,15
394	15,5"	4	10/64"	3,35	7,38
394	15,5"	5	13/64"	4,35	9,59
406	16"	3	88/64"	2,85	6,28
406	16"	3,5	9/64"	3,34	7,36
406	16"	4	10/64"	3,83	8,44
406	16"	5	13/64"	4,78	10,54
433	17"	4	10/64"	4,25	9,37
433	17"	4,5	11/64"	4,79	10,56
450	17,5"	4	10/64"	4,40	9,70
457	18"	3,5	9/64"	4,08	9,00
457	18"	4	10/64"	4,68	10,32
457	18"	4,5	11/64"	5,27	11,62
457	18"	5	13/64"	5,84	12,87
457	18"	6	15/64"	6,97	15,37
457	18"	7	18/64"	8,09	17,84
470	19"	5	13/64"	5,90	13,01
508	20"	3,5	9/64"	5,23	11,53
508	20"	4	10/64"	5,97	13,16
508	20"	4,5	11/64"	6,70	14,77
508	20"	5	13/64"	7,43	16,38
508	20"	6	15/64"	8,84	19,49

Good cut and penetration. Minimum tilling action.



FLAT DISC NOTCHED

DIAMETER D		THICKNESS		Weight	
mm	inch	mm	inch	kg	lb
255	10"	2,5	6/64"	0,92	2,03
255	10"	3,5	9/64"	1,22	2,69
282	11"	3	8/64"	1,35	2,98
305	12"	2	5/64"	1,08	2,38
305	12"	2,5	6/64"	1,35	2,98
305	12"	3	8/64"	1,78	3,92
305	12"	4	10/64"	2,00	4,41
333	13"	2,5	6/64"	1,62	3,57
333	13"	3	8/64"	1,81	3,99
333	13"	4	10/64"	2,46	5,42
343	13,5"	3	8/64"	2,00	4,41
343	13,5"	4	10/64"	2,70	5,95
351	14"	3	88/64"	2,13	4,69
351	14"	3,5	9/64"	2,50	5,51
351	14"	4	10/64"	2,86	6,30
351	14"	5	13/64"	3,56	7,85
381	15"	3	88/64"	2,50	5,51
381	15"	3,5	9/64"	2,87	6,33
381	15"	4	10/64"	3,28	7,23
381	15"	5	13/64"	4,15	9,15
394	15,5"	4	10/64"	3,35	7,38
394	15,5"	5	13/64"	4,35	9,59
406	16"	3	88/64"	2,85	6,28
406	16"	3,5	9/64"	3,34	7,36
406	16"	4	10/64"	3,83	8,44
406	16"	5	13/64"	4,78	10,54
433	17"	4	10/64"	4,25	9,37
433	17"	4,5	11/64"	4,79	10,56
450	17,5"	4	10/64"	4,40	9,70
457	18"	3,5	9/64"	4,08	9,00
457	18"	4	10/64"	4,68	10,32
457	18"	4,5	11/64"	5,27	11,62
457	18"	5	13/64"	5,84	12,87
457	18"	6	15/64"	6,97	15,37
457	18"	7	18/64"	8,09	17,84
470	19"	5	13/64"	5,90	13,01
508	20"	3,5	9/64"	5,23	11,53
508	20"	4	10/64"	5,97	13,16
508	20"	4,5	11/64"	6,70	14,77
508	20"	5	13/64"	7,43	16,38
508	20"	6	15/64"	8,84	19,49

Good cut and penetration with high residues. Minimum tilling action.



FLAT DISC NOTCHED

DIAMETER D		THICKNESS		Weight	
mm	inch	mm	inch	kg	lb
370	14"	5	13/64"	4,20	9,26
405	16"	4,5	11/64"	4,35	9,59
410	16"	5	13/64"	5,25	11,57
430	16"	5	13/64"	5,80	12,79
445	17"	5	13/64"	6,20	13,67

Good cut and penetration with high residues. Minimum tilling action.



DISCS FOR SEEDERS

WAVED DISC 50 ONDULATION

DIAMETER D		THICKNESS		Weight		G
mm	inch	mm	inch	kg	lb	mm
406	16"	4	10/64"	3,83	8,44	47
406	16"	4,5	11/64"	4,30	9,48	47
406	16"	5	13/64"	4,78	10,54	47
423	16"	3,5	9/64"	3,48	7,67	56
423	16"	4	10/64"	3,99	8,80	56
423	16"	5	13/64"	4,98	10,98	56
433	17"	3,5	9/64"	3,70	8,16	61
433	17"	4	10/64"	4,25	9,37	61
433	17"	4,5	11/64"	4,79	10,56	61
457	18"	4	10/64"	4,68	10,32	73
457	18"	5	13/64"	5,84	12,87	73
508	20"	4	10/64"	5,97	13,16	73
508	20"	4,5	11/64"	5,70	12,57	73
508	20"	5	13/64"	7,43	16,38	73

Good cut and penetration.
Minimum tilling action, ideal for variable soil conditions.

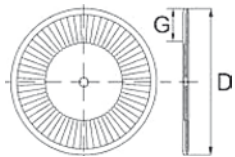

WAVED DISC 55 ONDULATION

DIAMETER D		THICKNESS		Weight		G
mm	inch	mm	inch	kg	lb	mm
508	20"	4,5	11/64"	6,70	14,77	70
508	20"	5	13/64"	7,43	16,38	70
582	22"	4,5	11/64"	8,86	19,53	89
582	22"	5	13/64"	9,82	21,65	89
582	22"	6	15/64"	11,17	24,63	89

Good cut and penetration.
Minimum tilling action, ideal for variable soil conditions.

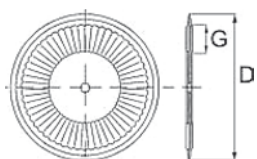

WAVED DISC 22 ONDULATION

DIAMETER D		THICKNESS		Weight		Ø	N. WAVES ONDULATION
mm	inch	mm	inch	kg	lb	mm	
404	16"	4	10/64"	3,83	8,44	19	22
404	16"	4,5	11/64"	4,30	9,48	19,5	22
404	16"	5	13/64"	4,78	10,54	20	22

Moderate penetration and tilling action. Good cut.
Possible compacting in humid soil.

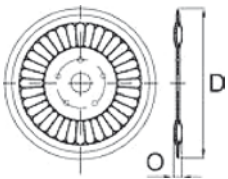

WAVED DISC

DIAMETER D		THICKNESS		Weight	
mm	inch	mm	inch	kg	lb
380	15"	4	5/32"	2,5	5,5
406	16"	4	5/32"	3,6	8,0
430	16" 59/64	4	5/32"	4,2	9,26
450	17" 23/32	5	15/64"	5,3	11,7
460	18"	4	5/32"	5,0	11,0
510	20"	4	5/32"	7,3	16,1
560	22"	5	15/64"	9,0	19,8



DISCS FOR SEEDERS

SPECIAL DISC

c		STAMP CODE 094					
DIAMETER D		THICKNESS		Weight			
mm	inch	mm	inch	kg	lb		
305	12"	3	8/64"	1,08	2,38		
333	13"	3	8/64"	1,81	3,99		
351	14"	3	8/64"	2,13	4,69		
381	15"	3	8/64"	2,50	5,51		



DISC WITH FLAT CENTER

c		STAMP CODE 067					
DIAMETER D		THICKNESS		Weight			
mm	inch	mm	inch	kg	lb		
305	12"	3	8/64"	1,78	3,92		
320	13"	3	8/64"	1,80	3,99		
333	13"	3	8/64"	1,83	4,03		
351	14"	3	8/64"	2,13	4,69		
381	15"	3	8/64"	2,50	5,51		
351	16"	4	10/64"	3,83	8,44		



DISC WITH FLAT CENTER

c		STAMP CODE 029					
DIAMETER D		THICKNESS		Weight			
mm	inch	mm	inch	kg	lb		
305	12"	2,5	6/64"	1,40	3,10		
320	13"	2,5	6/64"	1,55	3,42		



DISC WITH FLAT STUFFING CENTER

c		STAMP CODE 039					
DIAMETER D		THICKNESS		Weight			
mm	inch	mm	inch	kg	lb		
305	12"	3	8/64"	1,78	3,92		
320	13"	3	8/64"	1,80	3,99		
333	14"	3	8/64"	1,83	4,03		
351	15"	3	8/64"	2,13	4,69		



STAR DISC

DIAMETER D		A LARGE		THICKNESS		WEIGHT
mm	inch	mm	inch	mm	inch	kg
351	13" 13/16	6	15/64"	6	15/64"	-
351	13" 13/16	8	20/64"	8	20/64"	-



DISCS FOR SEEDERS

FLAT DISC NOTCHES _ Standard

DIAMETER inch		Number of notches	A	B
mm	inch		mm	mm
280	11"	8	60	35
305	12"	8	60	35
333	13"	9	60	35
351	14"	10	60	35
381	15"	10	60	35
406	16"	10	60	40
433	17"	10	80	40
457	18"	12	80	40
508	20"	12	80	40

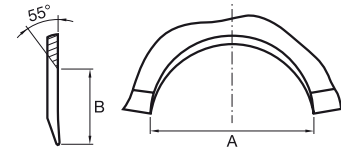

FLAT DISC NOTCHES _ Mini-notch

DIAMETER inch		Number of notches	A	B
mm	inch		mm	mm
406	16"	20	22	11
457	18"	20	22	11
508	20"	20	22	11

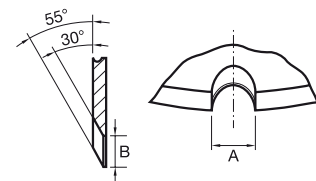

FLAT DISC NOTCHES _ Special V shape

DIAMETER inch		Number of notches	A	B
mm	inch		mm	mm
457	18"	14	62,5	25
508	20"	14	62,5	25

Only for discs with double bevel

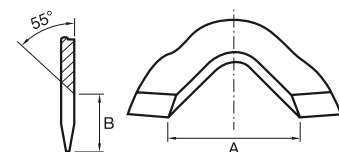

FLAT DISC BEVELS _ Simple 15° bevel

THICKNESS mm	L mm	H mm
2	4,5	0,8
2,5	6	0,8
3	7,5	0,8
3,5	9,5	0,8
4	11	1
4,5	13	1
5	15	1
6	18	1
7	20	1,2
8	22	1,6

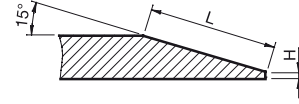

FLAT DISC BEVELS _ Simple 30° bevel

THICKNESS mm	L mm	H mm
3	3,5	0,8
3,5	4,5	0,8
4	5	0,8
4,5	6	0,1
5	7	0,1
6	8	0,1

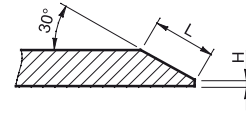

FLAT DISC BEVELS _ Double 20° bevel

THICKNESS mm	L mm	H mm
2	3,5	0,8
2,5	4,5	0,8
3	5,5	0,8
3,5	7	0,8
4	8,5	0,8
4,5	10	0,8
5	11,5	0,8
6	14	0,8
7	17	0,8
8	19,5	0,8

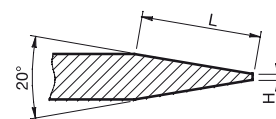

10 degrees per side

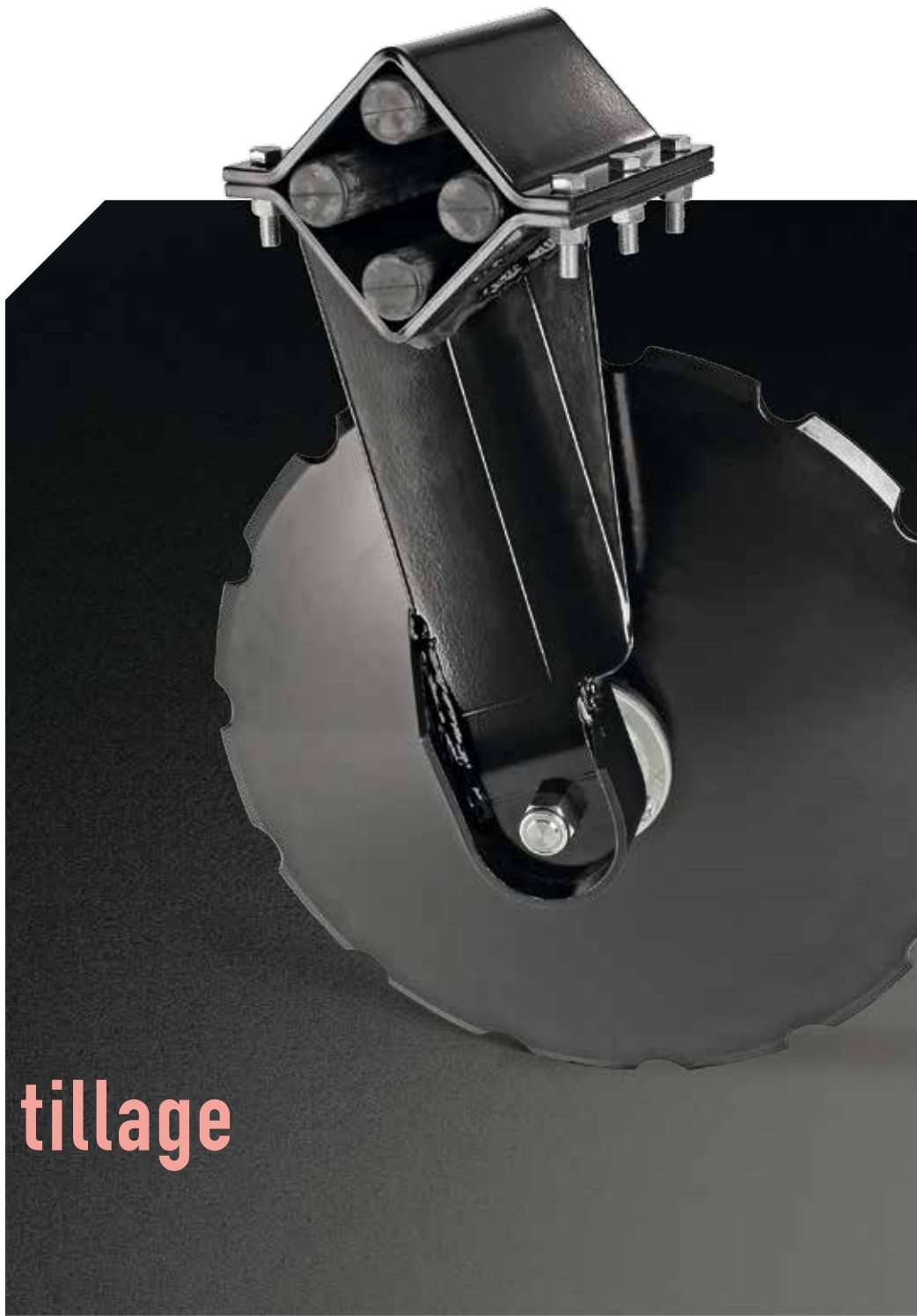

Rapid tillage





RAPID TILLAGE

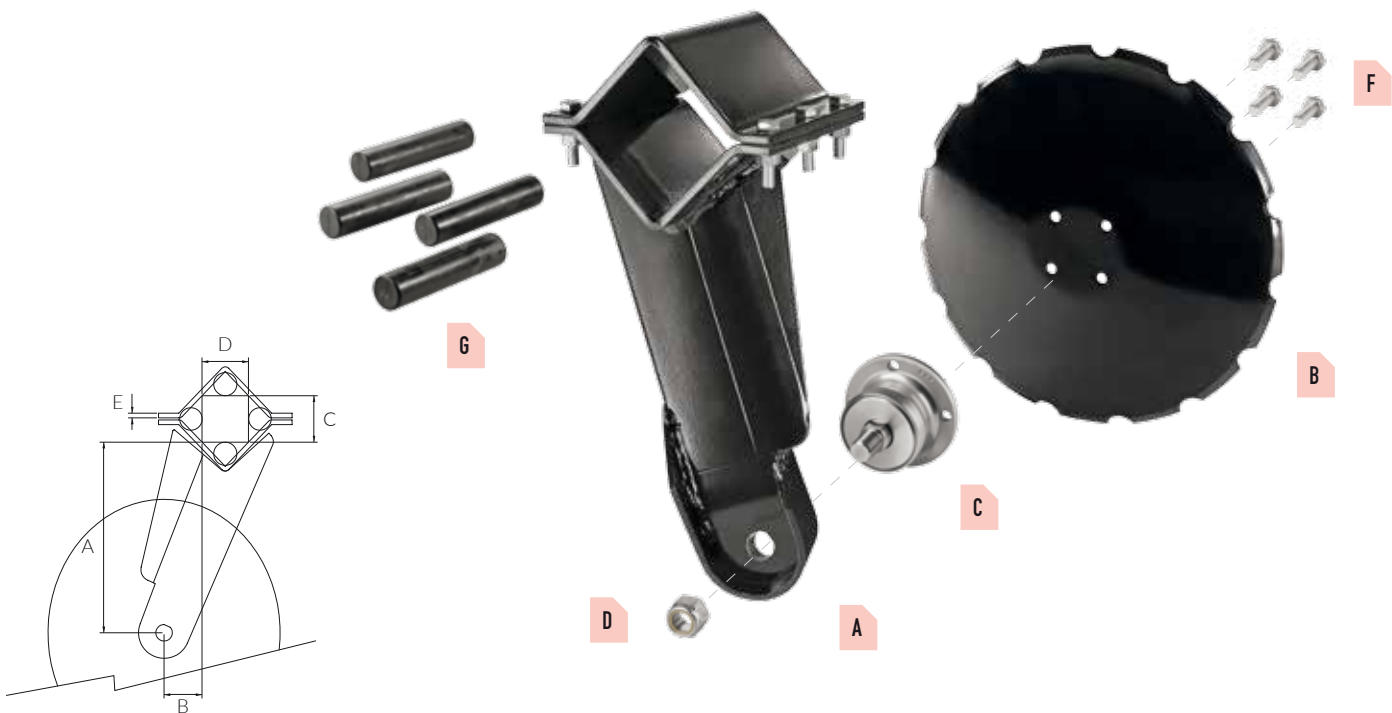

CULTIVATOR DISC SYSTEM COMPONENTS

	COD.	DESCRIPTION	DIMENSION		FRAME C/D mm	PCS	NOTE
			A mm	B mm			
A	ZOFS0003	support	392	40	100 x 100	1	rear
A	ZOFS0004	support	392	40	100 x 100	1	front
A	ZOFS0005	support	330	65	80 x 80	1	rear
A	ZOFS0006	support	330	65	80 x 80	1	front
B	D610 x 6 D	disc	610	6	5T13D112	1	
B	D560 x 6 D	disc	560	6	5T13D112	1	
B	D510 x 5 D	disc	510	5	5T13D98	1	
B	D460 x 5 D	disc	460	5	5T13D98	1	
C	BAA0004	hub	117	M22x1,25	80 x 80	1	4T1398
C	HUB35	hub	140	M24x2	100 x 100	1	5T13112
C	HUB35+180	hub	180	M24x2	100 x 100	1	6T13150
D	NUT KIT	nut				1	M24x2
F	SCREW KIT	screw				5	12x1,5
G	G 40 x 180	silent block	40	180	80 x 80	1	
G	G 40 x 200	silent block	40	200	80 x 80	1	
G	G 40 x 230	silent block	40	230	80 x 80	1	
G	G 50 x 190	silent block	50	190	100 x 100	1	
G	G 50 x 210	silent block	50	210	100 x 100	1	
G	G 50 x 240	silent block	50	240	100 x 100	1	



DISC TINES

	COD.	DIMENSION		PCS	NOTE
		A mm	B mm		
A	317021 DX	90	13		internal
A	317031 SX	90	13		internal
A	317025 DX	90	13		external
A	317035 SX	90	13		external



DISC TINES

	COD.	DIMENSION		PCS	NOTE
		A mm	B mm		
A	317061 DX	100	16		internal
A	317071 SX	100	16		internal
A	317065 DX	100	16		external
A	317075 SX	100	16		external
A	317021 DX	120	20		internal
A	317031 SX	120	20		internal



DISC TINES SYSTEM COMPONENTS

	COD.	DESCRIPTION	DIMENSION		TINES	FRAME	PCS	NOTE
			A mm	B mm				
B	510 x 4 DSFC + 4T - 13 su D98	disc	510	40	4		1	
B	510 x 4 DSFC + 5T - 13 su D98	disc	510	40	4		1	
B	560 x 6 DSFC + 5T - 13 su D112	disc	560	60	6		1	
B	610 x 6 DSFC + 5T - 13 su D112	disc	610	60	6		1	
B	660 x 6 DSFC + 5T - 13 su D140	disc	660	60	6		1	
C	BAA0004	hub	117	M22x1,25			1	4T13D98
C	BAA0012	hub	117	M22x1,25			1	5T13D98
C	HUB-40	hub	178	M27x2			1	4T13D140
D	NUT KIT x BAA0004	nut					1	M22x1,25
F	SCEW KIT x BAA0004	screw					4/5	M12x1,25
G	P372SMR	clamp	140	12	100x16	60x60/70x70/80x80		
G	P373SMR	clamp	200	16	120x120	100x100		

Rapid tillage Subsoiler Blades





SUBSOILER / BLADES



BLADES 800

	COD.	WEIGHT kg	DIMENSION		HOLES C mm	THICKNESS SP mm
			A mm	B mm		
A-D4	OF802	23,20	300	820	30	15
A-I4	OF803	23,20	300	820	30	15

A-D 4
A-I 4



BLADES 800

	COD.	WEIGHT kg	DIMENSION		HOLES C mm	THICKNESS SP mm
			A mm	B mm		
B-D	OF804	5,05	295	295	16	8
B-I	OF805	5,05	295	295	16	8
C-D	OF806	7,83	295	465	16	8
C-I	OF809	7,83	295	465	16	8

B-D
B-I

C-D
C-I

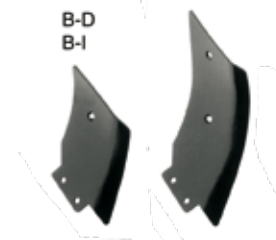

BLADES 800

	COD.	WEIGHT kg	DIMENSION		HOLES C mm	THICKNESS SP mm	
			A mm	B mm			
D	OF807	7,20	580	40	16	60	
E	OF810	3,80	314	60	16	60	
F	OF811	1,85	147	67	16	60	
G	OF808	- Assembly Kit -					

D

E

F

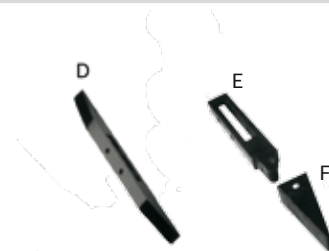

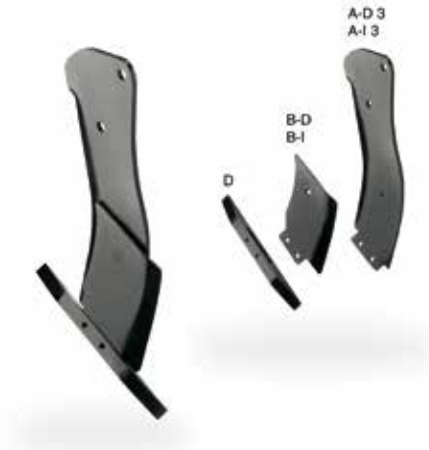

BLADES 600

	COD.	WEIGHT kg	DIMENSION		HOLES C mm	THICKNESS SP mm
			A mm	B mm		
A-D3	OF600	10,500	295	465	25	15
A-I3	OF601	10,500	295	465	25	15

A-D3
A-I3



BLADES 600

	COD.	WEIGHT kg	DIMENSION		HOLES C mm	THICKNESS SP mm
			A mm	B mm		
B-D	OF604	2,650	250	230	14	8
B-I	OF605	2,650	250	230	14	8

B-D
B-I



BLADES 600

	COD.	WEIGHT kg	DIMENSION		HOLES C mm	THICKNESS SP mm	
			A mm	B mm			
D	OF607	4,230	50	510	14	50	
E	OF608	- Assembly Kit -					

D

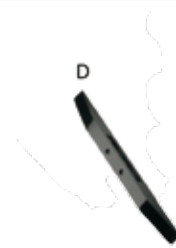

BLADES

CULTIVATOR TINES

	COD.	WEIGHT	DIMENSION			HOLES	THICKNESS
		kg	A mm	B mm	C mm	T mm	SP mm
A	OF700	9,800	875	85	43	D.13	22
B	OF701	2,350	150	194	40/70	M12	10
C	OF702	1,750	120	235	-	M12	10
D	OF703	1,850	100	295	-	M12	8
F	OF705	2,400	110	300	-	M12	8
G	OF706	2,400	110	300	-	M12	8
H	OF707	2,035	349	130	70	M12	10
I	OF708	2,035	349	130	70	M12	10
M	OF709	2,100	349	130	70	M12	10
N	OF710	2,100	349	130	70	M12	10



Spring Tines and Sweep





SPRING TINES AND SWEEP

SPRING TINE

S. TINE Cod.	A mm	B mm	THICKNESS mm	F mm - HOLE DISTANCE	WEIGHT kg	Pcs	NOTE
360 MF 10	230	550	10	-	2,66	250	N° 1 hole 13 mm
360 MF 12	230	550	12	-	3,1	250	N° 1 hole 13 mm

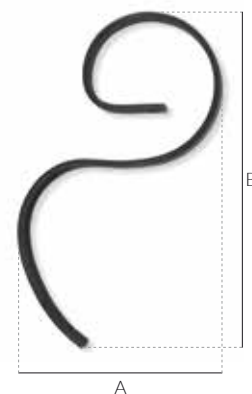

HELPER FOR S. TINE

S. TINE Cod.	A mm	B mm	THICKNESS mm	F mm - HOLE DISTANCE	WEIGHT kg	Pcs	NOTE
365 RI 32x10	180	210	10	-	1,46	250	N°1 hole 13 mm

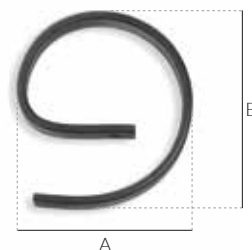

HELPER WITH EYE

S. TINE Cod.	A mm	B mm	THICKNESS mm	F mm - HOLE DISTANCE	WEIGHT kg	Pcs	NOTE
366 RIO 32x10	185	180	10	-	1,5	250	N°1 hole 13 mm



SPRING TINES FOR CULTIVATOR

S. TINE Cod.	A mm	B mm	THICKNESS mm	WEIGHT kg	Pcs	NOTE
361 MFSV	190	400	10	1,670	400	N°1 hole 13 mm
361 MFCV	190	400	10	1,880	400	N°1 hole 13 mm



SPRING TINES FOR CULTIVATOR

S. TINE Cod.	A mm	B mm	THICKNESS mm	WEIGHT kg	Pcs	NOTE
362 MFSV	225	525	12	2,450	250	N°1 hole 13 mm
362 MFCV	225	525	12	2,930	250	N°1 hole 13 mm
376 MFSV	225	525	10	2,120	250	N°1 hole 13 mm
376 MFCV	225	525	10	2,510	250	N°1 hole 13 mm

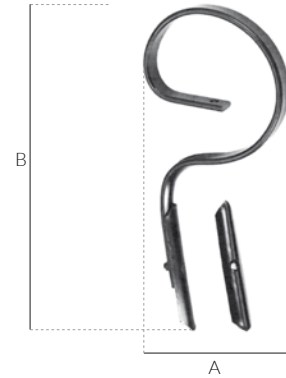

SPRING TINES TITAN

S. TINE Cod.	A mm	B mm	THICKNESS mm	WEIGHT kg	Pcs	NOTE
363 MTS	415	780	150x12	17,310	-	-
363 MTV	415	780	150x12	18,350	-	-
356 MTS	460	907	150x14	23,250	-	-
356 MTV	460	907	150x14	25,990	-	-

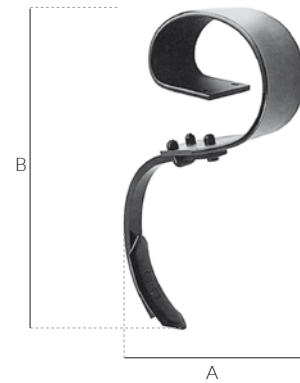

LEVELING TINES

L. TINE Cod.	A mm	B mm	THICKNESS mm	WEIGHT kg	Pcs	NOTE
360 MF 45x10	509	234	45x10	3,18	200	2 holes for point
364 MFL	509	234	45x10	3,16	200	3 holes for point
365 MFL	516	260	45x10	3,35	200	3 holes for point

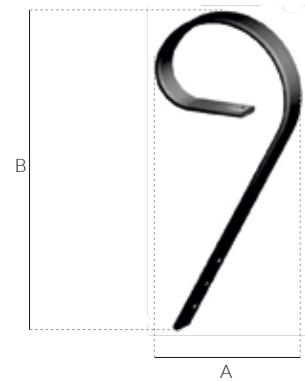

LEVELING TINES

L. TINE Cod.	A mm	B mm	THICKNESS mm	WEIGHT kg	Pcs	NOTE
366 MFL	516	260	80x10	6,10	112	3 holes
367 MFL	500	260	80x10	6,02	112	1 hole - 2 slots
368 MFL	385	260	80x10	5,14	112	3 holes for point

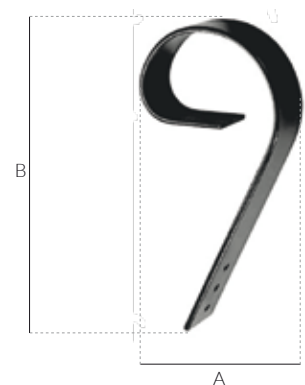

SPRING TINES AND SWEEP

SPRING TINES FOR CULTIVATOR

S. TINE Cod.	A mm	B mm	C mm	E mm	F mm	THICKNESS mm	WEIGHT kg	Pcs	NOTE
391 MFS	11	11	14,5	325	660	45x12	5,6	150	-
394 MFS	11	-	14,5	325	660	45x12	5,6	150	-

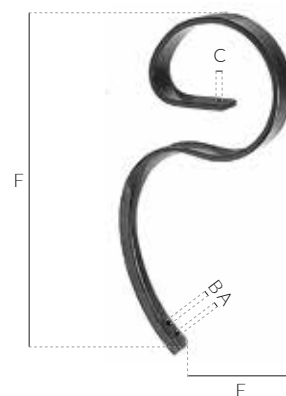

HELPER EYE FOR S. TINE

S. TINE Cod.	A mm	B mm	C mm	E mm	F mm	THICKNESS mm	WEIGHT kg	Pcs	NOTE
392 MRS	-	-	14,5	215	-	45x10	2,60	250	-



DOUBLE TINES

S. TINE Cod.	A mm	B mm	C mm	THICKNESS mm	WEIGHT kg	Pcs	NOTE
368 MQA DX	365	535	17	30x30	12,50	80	-
368 MQA SX	365	535	17	30x30	12,50	80	-

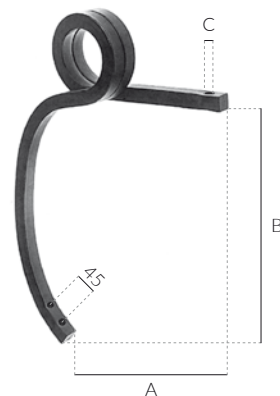

DOUBLE TINES

S. TINE Cod.	A mm	B mm	C mm	THICKNESS mm	WEIGHT kg	Pcs	NOTE
369 MQB DX	310	635	17	35X35	13,56	80	-
369 MQB SX	310	635	17	35X35	13,56	80	-

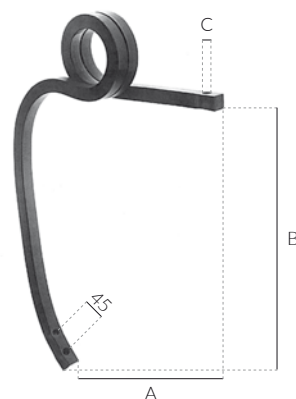

SPRING TINES

S. TINE Cod.	A mm	B mm	THICKNESS mm	WEIGHT kg	Pcs	NOTE
387 MFS	325	730	70x12	9,320	78	-
388 MFS	325	-	80x12	11,18	60	-

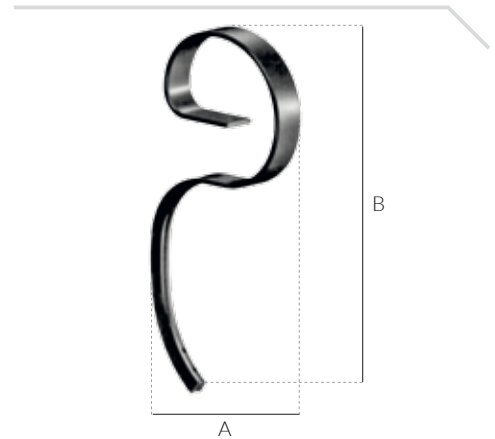

HELPER WITH EYE FOR S. TINE

S. TINE Cod.	A mm	B mm	THICKNESS mm	WEIGHT kg	Pcs	NOTE
388 RIO	-	-	70x10	4,90	156	-
389 RIO	-	-	80x10	5,50	120	-



DOUBLE TINES

S. TINE Cod.	A mm	B mm	C mm	THICKNESS mm	WEIGHT kg	Pcs	NOTE
364 MQB DX	365	455	13	25x25	8,200	100	-
364 MQB SX	365	455	13	25x25	8,200	100	-
350 MQS DX	370	415	12	20x20	4,400	200	2x10x45
350 MQS SX	370	415	12	20x20	4,400	200	2x10x45
351 MQS DX	370	415	14	20x20	4,400	200	2x12x45
351 MQS SX	370	415	14	20x20	4,400	200	2x12x45
352 MQS DX	437	507	16	26x26	9,500	80	2x12x45
352 MQS SX	437	507	16	26x26	9,500	80	2x12x45
353 MQS DX	437	507	16	27x27	10,500	80	2x12x45
353 MQS SX	437	507	16	27x27	10,500	80	2x12x45
354 MQS DX	437	507	22	27x27	10,500	80	2x12x45
354 MQS SX	437	507	22	27x27	10,500	80	2x12x45

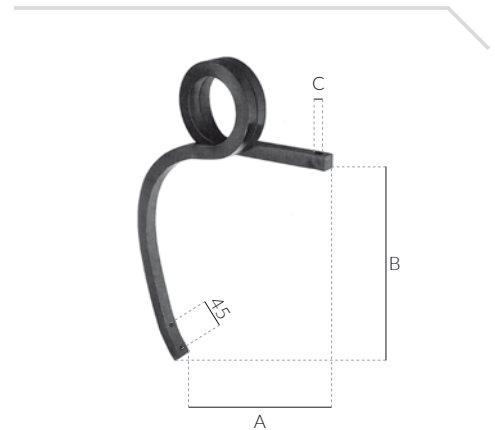

DOUBLE TINES

S. TINE Cod.	A mm	B mm	C mm	THICKNESS mm	WEIGHT kg	Pcs	NOTE
367 MQB DX	365	535	17	30x30	12,50	80	-
367 MQB SX	365	535	17	30x30	12,50	80	-
355 MQS DX	438	540	22	32x32	17,00	50	2x12x45
355 MQS SX	438	540	22	32x32	17,00	50	2x12x45

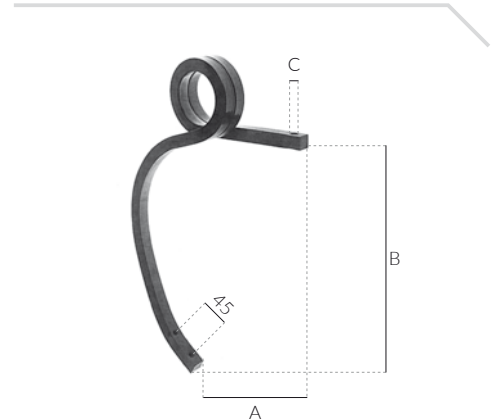

SPRING TINES AND SWEEP

DOUBLE TINES

S. TINE Cod.	A mm	B mm	C mm	THICKNESS mm	WEIGHT kg	Pcs	NOTE
370 MQB DX	435	680	21	40X40	31,80	30	-
370 MQB SX	435	680	21	40X40	31,80	30	-

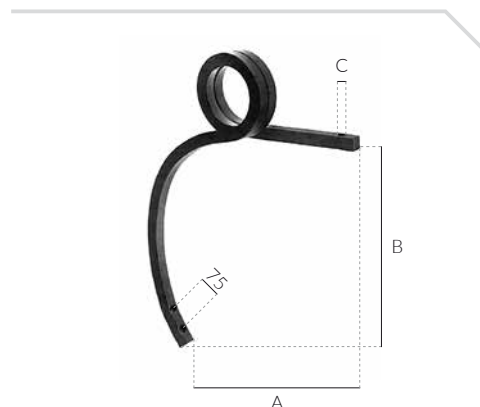

SPRING CHISEL TINES

S. TINE Cod.	A mm	B mm	C mm	D mm	THICKNESS mm	WEIGHT kg	Pcs	NOTE
373	500	600	655	21	55X20X20	16,80	80	-
374	500	600	655	21	55X25X20	18,97	80	-
375	500	600	655	21	55X25X25	20,90	80	-

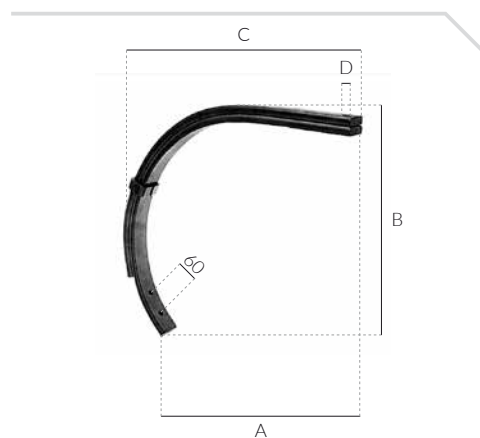

SPRING CHISEL TINES

S. TINE Cod.	A mm	B mm	C mm	E mm	F mm	THICKNESS mm	WEIGHT kg	Pcs	NOTE
320 CS	16	12	12	400	374	25x25	3,25	200	-
321 CS	16	12	12	470	397	30x30	5,54	200	-
322 CS	16	12	12	460	395	32x32	6,30	100	-
323 CS	16	12	12	465	395	35x35	7,55	100	-
324 CS	18	12	24x14	495	368	40x30	7,10	200	-
325 CS	24	14	14	470	502	40x40	11,00	100	-
326 CS	16	12	24x12	500	355	45x20	5,10	200	-
327 CS	20	12	24x12	450	582	50x25	10,55	100	-
328 CS	20	12	24x12	455	587	50x30	12,50	100	-
329 CLS	18	12	24x14	472	505	40x30	8,50	100	-
330 CLS	24	14	24x14	525	575	40x40	12,70	100	-

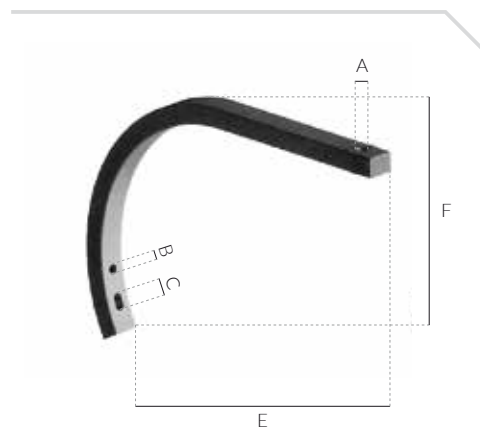

CLAMP FOR SPRING AND BOLT

BRAKE Cod.	DESCRIPTION	DIMENS. mm	S. TINE	HELPER	FRAME	WEIGHT kg	Pcs
386 SM 60	single blade	110x10	80x12	-	60x60	1,36	20
386 SM 70	single blade	110x10	80x12	-	70x70	1,51	20
386 SM 80	single blade	110x10	80x12	-	80x80	1,79	20
386 BB 60	double blade	110x10	80x12	8x10	60x60	1,42	20
386 BB 70	double blade	110x10	80x12	8x10	70x70	1,61	20
386 BB 80	double blade	110x10	80x12	8x10	80x80	1,83	20



CLAMP FOR SPRING AND BOLT

BRAKE Cod.	DESCRIPTION	DIMENS. mm	S. TINE	HELPER	FRAME	WEIGHT kg	Pcs
385 SM 70	single blade	70x8	45x12	-	50x50	0,590	20
385 SM 71	single blade	70x8	45x12	-	60x60	0,680	20
385 SM 72	single blade	70x8	45x12	-	65x65	0,710	20
385 SM 73	double blade	70x8	45x12	45x10	50x50	0,630	20
385 SM 74	double blade	70x8	45x12	45x10	60x60	0,720	20
385 SM 75	double blade	70x8	45x12	45x10	65x65	0,750	20



CLAMP FOR SPRING AND BOLT

BRAKE Cod.	DESCRIPTION	DIMENS. mm	S. TINE	HELPER	FRAME	WEIGHT kg	Pcs
370 SM 50	single blade	50x6	32x10	-	50x12	0,245	25
370 SM 51	single blade	50x6	32x10	-	50x15	0,250	25
370 SM 52	single blade	50x6	32x12	-	50x15	0,255	25
370 SB 53	double blade	50x6	32x10	32x10	50x12	0,250	25
370 SB 54	double blade	50x6	32x10	32x10	50x15	0,255	25
370 SB 55	double blade	50x6	32x12	32x10	50x15	0,260	25
370 SM 60	single blade	50x6	32x10	-	50x50	0,320	25
370 SM 61	single blade	50x6	32x12	-	50x50	0,325	25
370 SB 70	double blade	50x6	32x10	32x10	50x50	0,325	25
370 SB 71	double blade	50x6	32x12	32x10	50x50	0,330	25



CLAMP FOR SPRING AND BOLT

BRAKE Cod.	DESCRIPTION	DIMENS. mm	S. TINE	HELPER	FRAME	WEIGHT kg	Pcs
371 SMR 50	single blade	50x8	32x10	-	50x12	0,295	25
371 SMR 51	single blade	50x8	32x10	-	50x15	0,300	25
371 SMR 52	single blade	50x8	32x12	-	50x15	0,305	25
371 SBR 53	double blade	50x8	32x10	32x10	50x12	0,305	25
371 SBR 54	double blade	50x8	32x10	32x10	50x15	0,310	25
371 SBR 55	double blade	50x8	32x12	32x10	50x15	0,315	25



CLAMP FOR SPRING AND BOLT

BOLT Cod.	A mm	B mm	THICKNESS mm	F mm - HOLE DISTANCE	WEIGHT kg	Pcs	NOTE
380 BU 35	10	35	-	-	0,044	250	-



REVERSIBLE POINT

REVERSIBLE POINT

REVERSIBLE POINT Cod.	A mm	B mm	C mm	F mm - HOLE DISTANCE	WEIGHT kg	Pcs	NOTE
376 L 400 2 F	130	440	2 F 13,5	45-75	3,240	10	-

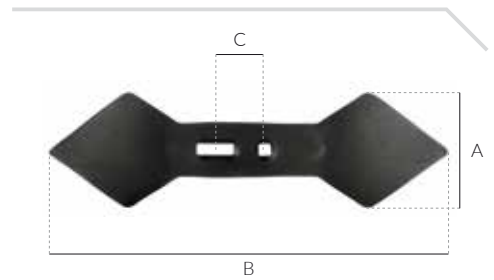

REVERSIBLE POINT

REVERSIBLE POINT Cod.	A mm	B mm	C mm	F mm - HOLE DISTANCE	WEIGHT kg	Pcs	NOTE
377 L 400 3 F	130	440	3 F 13,5	45-75	3,240	10	-

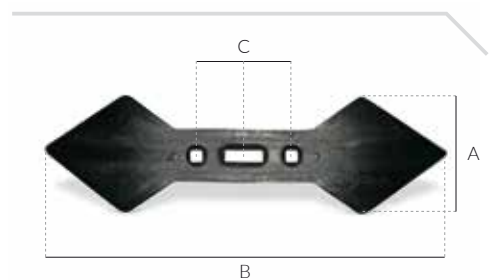

REVERSIBLE POINT

REVERSIBLE POINT Cod.	A mm	B mm	THICKNESS mm	C mm - HOLE DIAMETER	WEIGHT kg	Pcs	NOTE
384 MLS	260	60	6	10,5	0,65	25	N°1 bolt 10x45 mm

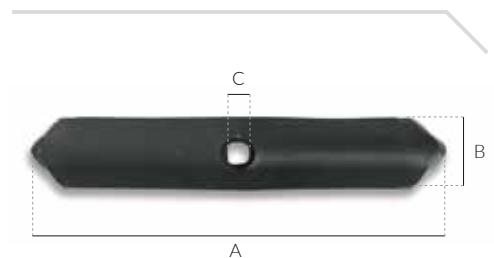

REVERSIBLE POINT

REVERSIBLE POINT Cod.	A mm	B mm	THICKNESS mm	C mm - HOLE DISTANCE	WEIGHT kg	Pcs	NOTE
385 M 80x12	300	60	10	12-45	1,35	-	Spring 80x12
386 M 80x12	330	70	12	12-45	2,16	-	Spring 80x12

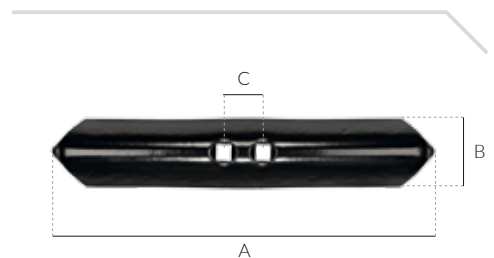

REVERSIBLE POINT

REVERSIBLE POINT Cod.	A mm	B mm	THICKNESS mm	F mm - HOLE DISTANCE	WEIGHT kg	Pcs	NOTE
190 L 19x5	190	36,5	5	-	0,28	20	N°1 hole 10,5 mm
190 L 19x6	190	36,5	6	-	0,34	20	N°1 hole 10,5 mm
195 D 13x5	135	36,5	5	-	0,18	20	N°1 hole 10,5 mm
210 D 210x6	210	36,5	6	-	0,36	20	N°1 hole 10,5 mm



REVERSIBLE POINT

REVERSIBLE POINT Cod.	A mm	B mm	THICKNESS mm	F mm - HOLE DISTANCE	WEIGHT kg	Pcs	NOTE
190 L 21x8	210	39	8	-	0,48	20	N°1 hole 10,5 mm
190 L 26x6	260	60	6	-	0,65	25	N°1 hole 10,5 mm



REVERSIBLE POINT

REVERSIBLE POINT Cod.	A mm	B mm	THICKNESS mm	F mm - HOLE DISTANCE	WEIGHT kg	Pcs for BOX	NOTE
190 L 25x6	250	65,5	6	45-50	0,64	25	N°2 holes 13 mm
190 L 28x6	280	65,5	6	45-50	0,73	25	N°2 holes 13 mm



REVERSIBLE POINT

REVERSIBLE POINT Cod.	A mm	B mm	THICKNESS mm	F mm - HOLE DISTANCE	WEIGHT kg	Pcs for BOX	NOTE
190 LR 30	295	110	5	45	0,90	10	N°2 holes 14 mm
190 R 32	300	110	9	45	1,50	20	N°2 holes 14 mm



SWEEP POINT

REVERSIBLE POINT

REVERSIBLE POINT Cod.	A mm	B mm	THICKNESS mm	F mm - HOLE DISTANCE	WEIGHT kg	Pcs for BOX	NOTE
190L60x15	300	60	15	50,8	-	10	N°2 holes 14 mm



REVERSIBLE POINT

REVERSIBLE POINT Cod.	A mm	B mm	THICKNESS mm	F mm - HOLE DISTANCE	WEIGHT kg	Pcs for BOX	NOTE
190L60x20FF	410	60	20	55-65	-	-	N°2 holes 17 mm N°1 slots 27 mm

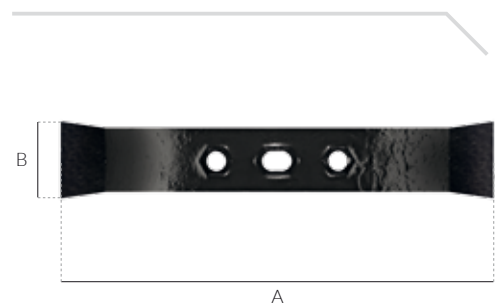

REVERSIBLE POINT

REVERSIBLE POINT Cod.	A mm	B mm	THICKNESS mm	F mm - HOLE DISTANCE	WEIGHT kg	Pcs for BOX	NOTE
190L60x20	410	60	20	55-65	-	-	N°2 holes 17 mm N°1 slots 27 mm



REVERSIBLE POINT TWIST_3 HOLES_2 SLOTS

REVERSIBLE POINT Cod.	A mm	B mm	THICKNESS mm	F mm - HOLE DISTANCE	WEIGHT kg	Pcs for BOX	NOTE
7690	485	75	10	45-75	2,80	10	N°3 holes 13 mm N°2 slots 45 mm
7689	485	75	10	45-75	2,80	10	N°3 holes 13 mm N°2 slots 45 mm



REVERSIBLE POINT

REVERSIBLE POINT Cod.	A mm	B mm	THICKNESS mm	F mm - HOLE DISTANCE	WEIGHT kg	Pcs for BOX	NOTE
190 L 40x16	275	40	16	45	0,97	10	N°2 holes 12 mm

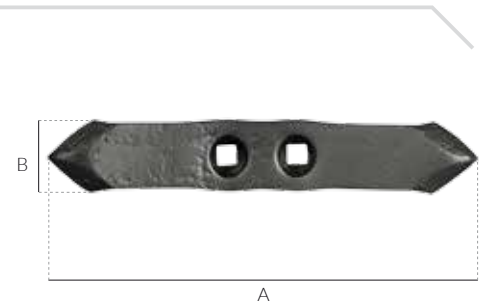

SWEEP POINT

SWEEP Cod.	A mm	B mm	THICKNESS mm	C mm - HOLE DIAMETER	WEIGHT kg	Pcs	NOTE
385 M25	200	200	6	10,5	0,75	20	N°2 bolt 10x55 mm

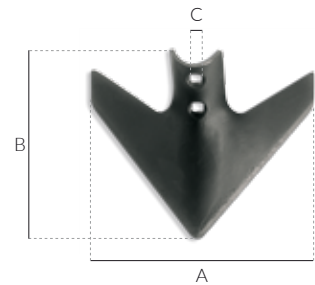

SWEEP POINT

SWEEP Cod.	A mm	B mm	THICKNESS mm	F mm - HOLE DISTANCE	WEIGHT kg	Pcs	NOTE
390 VE 200	200	-	8	45	1,76	-	Spring 80x12
390 VE 250	250	-	8	45	1,90	-	Spring 80x12
390 VE 300	300	-	8	45	2,08	-	Spring 80x12
390 VE 350	350	-	8	45	2,26	-	Spring 80x12

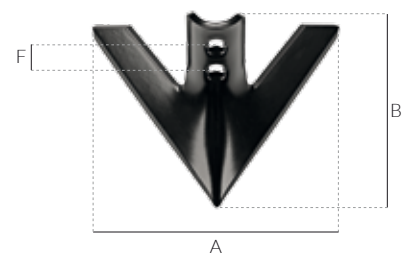

SWEEP FOR SEEDERS

SWEEP POINT

SWEEP Cod.	A mm	B mm	THICKNESS mm	F mm - HOLE DISTANCE	WEIGHT kg	Pcs	NOTE
120 CM 12	105	120	4,5	-	0,28	50	N°1 hole 11 mm



CONCAVE CENTRAL SWEEP

SWEEP Cod.	A mm	B mm	THICKNESS mm	F mm - HOLE DISTANCE	WEIGHT kg	Pcs	NOTE
120 CM 15	150	150	4,5	-	0,43	50	N°1 hole 11 mm
120 CM 17	175	145	4,0	-	0,45	25	N°1 hole 11 mm
120 CM 20	200	150	4,0	-	0,50	25	N°1 hole 11 mm
120 CM 25	250	185	4,0	-	0,59	25	N°1 hole 11 mm

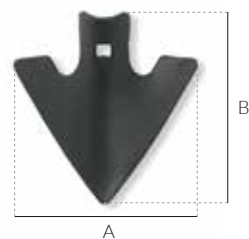

SWEEP POINT

SWEEP Cod.	A mm	B mm	THICKNESS mm	F mm - HOLE DISTANCE	WEIGHT kg	Pcs	NOTE
120 TS 20	200	172	4,5	45	0,59	50	N°2 holes 11 mm
OF551	70	180	6	40	0,450	25	N°2 holes 12 mm
OF552	100	165	8	40	0,665	25	N°2 holes 12 mm
OF553	185	180	7	40	0,86	25	N°2 holes 12 mm

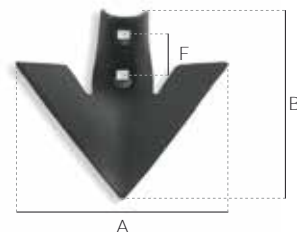

SWEEP POINT

SWEEP Cod.	A mm	B mm	THICKNESS mm	F mm - HOLE DISTANCE	WEIGHT kg	Pcs	NOTE
OF140	140	190	6	42	0,75	25	N°2 holes 12,5 mm
OF487	260	225	6	42	1,35	25	N°2 holes 12,5 mm
OF300	300	225	6	42	1,62	25	N°2 holes 12,5 mm

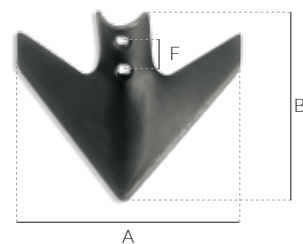

TILLER CENTRAL SWEEP

SWEEP Cod.	A mm	B mm	THICKNESS mm	F mm - HOLE DISTANCE	WEIGHT kg	Pcs for BOX	NOTE
130 CE 21T	130	230	6	45-50	-	20	N°2 holes 12 mm

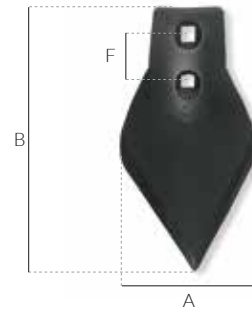

TILLER CENTRAL SWEEP

SWEEP Cod.	A mm	B mm	THICKNESS mm	F mm - HOLE DISTANCE	WEIGHT kg	Pcs for BOX	NOTE
130 CE 21	215	230	6	45-50	1,15	20	N°2 holes 12 mm

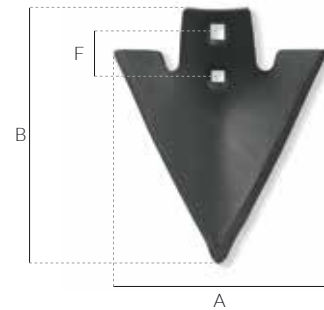

"SIRIA" CENTRAL SWEEP

SWEEP Cod.	A mm	B mm	THICKNESS mm	F mm - HOLE DISTANCE	WEIGHT kg	Pcs for BOX	NOTE
135 CS 22	220	184	6	45-50	1,07	20	N°2 holes 12 mm
135 CS 26	260	220	6	45-50	1,28	20	N°2 holes 12 mm

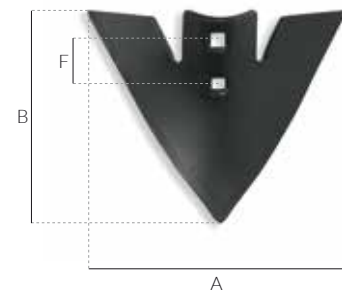

SWEEP FOR SEEDERS

SWEEP Cod.	A mm	B mm	THICKNESS mm	F mm - HOLE DISTANCE	WEIGHT kg	Pcs for BOX	NOTE
110 CN 12	120	120	3,5	16	0,30	50	N°2 holes 6 mm
110 CN 14	140	135	3,5	16	0,34	50	N°2 holes 6 mm
110 CN 16	160	145	3,5	16	0,36	50	N°2 holes 6 mm
110 CN 18	180	150	3,5	16	0,40	50	N°2 holes 6 mm
110 CN 20	200	165	3,5	16	0,48	50	N°2 holes 6 mm
110 CN 22	220	175	3,5	16	0,50	50	N°2 holes 6 mm
110 CN 24	240	180	3,5	16	0,57	25	N°2 holes 6 mm
110 CN 26	260	190	3,5	16	0,60	25	N°2 holes 6 mm
110 CN 28	280	210	3,5	16	0,63	25	N°2 holes 6 mm
110 CN 30	300	220	3,5	16	0,65	25	N°2 holes 6 mm

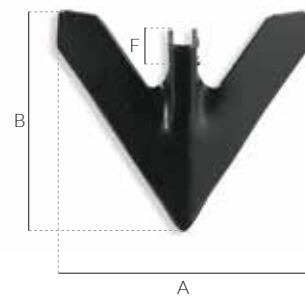

SWEEP FOR SEEDERS

LATERAL POINT

SWEEP Cod.	A mm	B mm	THICKNESS mm	F mm - HOLE DISTANCE	WEIGHT kg	Pcs for BOX	NOTE
150 LN 12 DX	120	220	3,5	36,5	0,49	25	N°2 holes 6,5 mm
150 LN 12 SX	120	220	3,5	36,5	0,49	25	N°2 holes 6,5 mm
150 LN 14 DX	140	250	3,5	36,5	0,53	25	N°2 holes 6,5 mm
150 LN 14 SX	140	250	3,5	36,5	0,53	25	N°2 holes 6,5 mm
150 LN 16 DX	160	270	3,5	36,5	0,56	25	N°2 holes 6,5 mm
150 LN 16 SX	160	270	3,5	36,5	0,56	25	N°2 holes 6,5 mm
150 LN 18 DX	180	300	3,5	36,5	0,62	25	N°2 holes 6,5 mm
150 LN 18 SX	180	300	3,5	36,5	0,62	25	N°2 holes 6,5 mm
150 LN 20 DX	200	320	3,5	36,5	0,65	25	N°2 holes 6,5 mm
150 LN 20 SX	200	320	3,5	36,5	0,65	25	N°2 holes 6,5 mm

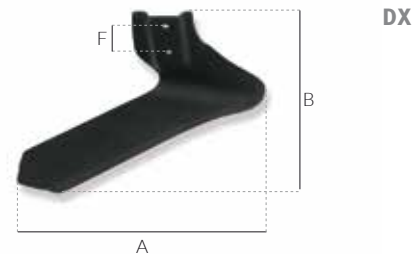

HEAVY CENTRAL SWEEP

SWEEP Cod.	A mm	B mm	THICKNESS mm	F mm - HOLE DISTANCE	WEIGHT kg	Pcs for BOX	NOTE
115 CP 22	220	210	5	35	0,95	10	N°2 holes 12 mm
115 CP 26	260	230	5	35	1,10	10	N°2 holes 12 mm
115 CP 30	300	260	5	35	1,30	10	N°2 holes 12 mm
115 CP 35	350	300	5	35	1,40	10	N°2 holes 12 mm



HEAVY CENTRAL SWEEP

SWEEP Cod.	A mm	B mm	THICKNESS mm	F mm - HOLE DISTANCE	WEIGHT kg	Pcs for BOX	NOTE
OF136X5WR	240	230	6	45	1,39	-	N°2 holes 12 mm



HEAVY CENTRAL SWEEP

SWEEP Cod.	A mm	B mm	THICKNESS mm	F mm - HOLE DISTANCE	WEIGHT kg	Pcs for BOX	NOTE
OF 8533	515	400	6	55	3,72	10	N°2 holes 16 mm

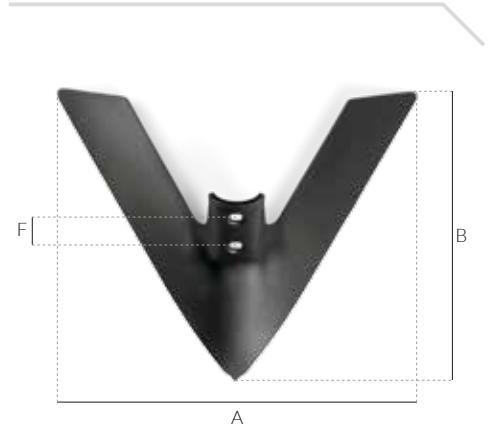

LATERAL POINT

SWEEP Cod.	A mm	B mm	THICKNESS mm	F mm - HOLE DISTANCE	WEIGHT kg	Pcs for BOX	NOTE
155 LP 22 DX	240	330	5	3,5	1,8	10	N°2 holes 11 mm
155 LP 22 SX	240	330	5	3,5	1,8	10	N°2 holes 11 mm

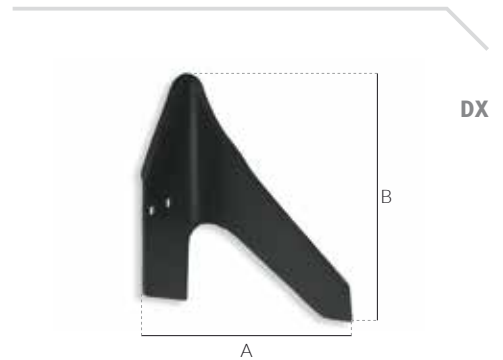

FLAT CENTRAL SWEEP

SWEEP Cod.	A mm	B mm	THICKNESS mm	F mm - HOLE DISTANCE	WEIGHT kg	Pcs for BOX	NOTE
125 CF 18	180	190	3,5	-	0,37	50	-
125 CF 28	280	245	4	-	0,84	25	-

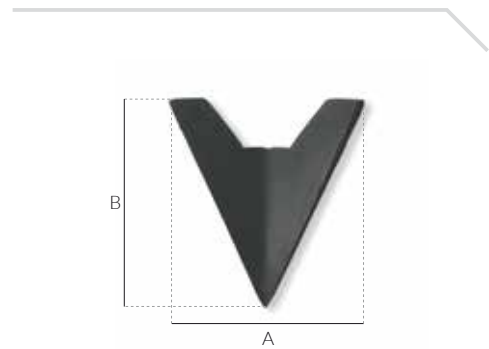

LATERAL POINT

SWEEP Cod.	A mm	B mm	THICKNESS mm	F mm - HOLE DISTANCE	WEIGHT kg	Pcs	NOTE
160 LF 12 DX	120	230	3,5	33	0,7	25	N°2 holes 11 mm
160 LF 12 SX	120	230	3,5	33	0,7	25	N°2 holes 11 mm
160 LF 17 DX	185	255	4,5	33	1,15	25	N°2 holes 11 mm
160 LF 17 SX	185	255	4,5	33	1,15	25	N°2 holes 11 mm

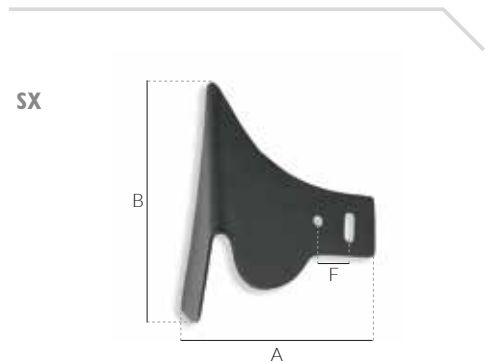

SPRING TINES AND SWEEP

CENTRAL POINT

SWEEP Cod.	A mm	B mm	THICKNESS mm	F mm - HOLE DISTANCE	WEIGHT kg	Pcs	NOTE
180 V 18	180	170	6	-	0,9	-	-
180 V 20	200	190	6	-	1,05	-	-
180 V 22	220	210	6	-	1,28	-	-
180 V 24	240	240	6	-	1,60	-	-
180 V 27	270	270	6	-	1,82	-	-

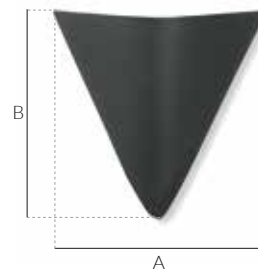

CENTRAL POINT

SWEEP Cod.	A mm	B mm	THICKNESS mm	F mm - HOLE DISTANCE	WEIGHT kg	Pcs	NOTE
180 V 30	300	320	6	90	2,70	-	N°2 holes 13 mm

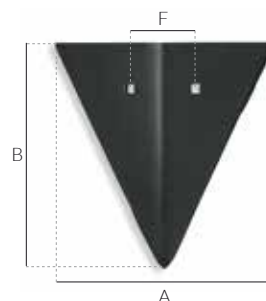

FULLER

SWEEP Cod.	A mm	B mm	THICKNESS mm	F mm - HOLE DISTANCE	WEIGHT kg	Pcs	NOTE
175 CR 34	330	335	4,5	43	2,40	-	N°1 hole 17 mm N°1 hole 23 mm
OF7304	300	430	6	50	3,83	-	N°1 hole 14 mm N°1 hole 24 mm
OF7305	460	500	6	55	5,70	-	N°2 hole 14 mm

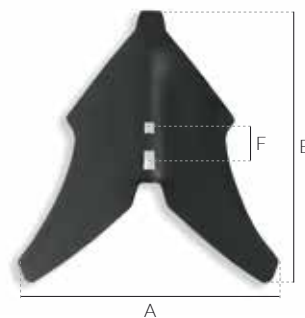

Blades for Feed Mixers and Loading Trailers



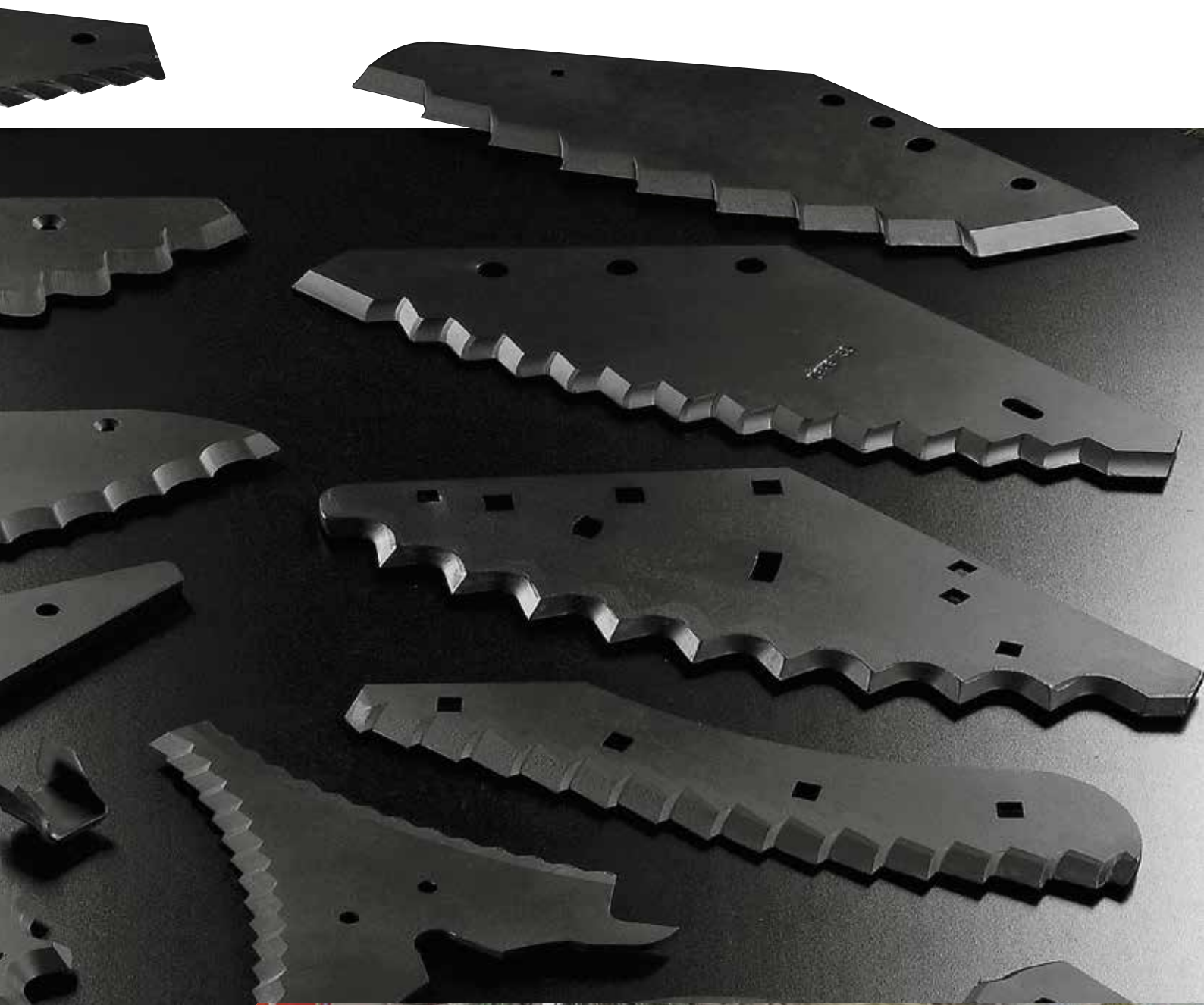

BLADES FOR THE FEED MIXERS

ART. 210 MB 13

Bend blade right
Holes dimension $\varnothing 6,5$ mm
thickness 3,5 mm
weight 0,10 kg.



ART. 255 MC 13

Bend blade right
Holes dimension $\varnothing 6,5$ mm
thickness 3,5 mm
weight 0,10 kg.



ART. 200 AL 94 DX - ART. 200 AL 94 SX

Bend blade right
Holes dimension $\varnothing 6,5$ mm
thickness 3,0 mm
weight 0,07 kg.

SX



ART. 200 RLT 95

Sleek round blade
Saturated hole $\varnothing 10,5$ mm
thickness 5,0 mm
weight 0,25 kg.



ART. 200 RL 95

Sleek round blade
Square hole 11x11 mm
thickness 5,0 mm
weight 0,25 kg.



ART. 200 RD 95

Toothed blade
Square hole 11x11 mm
thickness 5,0 mm
weight 0,19 kg.



ART. 200 RQ 85

Square sleek blade
Square hole 11x11 mm
thickness 5,0 mm
weight 0,22 kg.

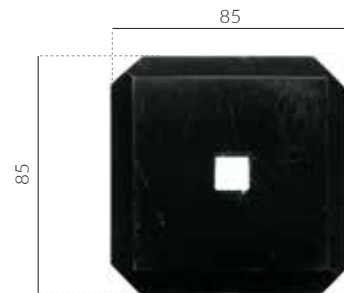

ART. 200 RQ 100

Square sleek blade
Square hole 11x11 mm
thickness 5,0 mm
weight 0,32 kg.

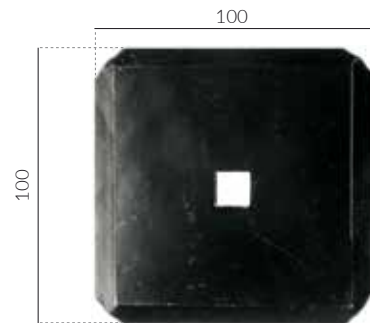

ART. 200 RQ 85/12

Round hole $\varnothing 12,5$ mm
thickness 5,0 mm
weight 0,22 kg.

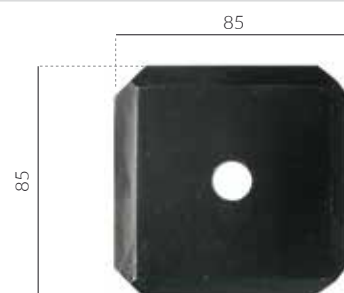

ART. 200 RQ 100/12

Round hole $\varnothing 12,5$ mm
thickness 5,0 mm
weight 0,32 kg.

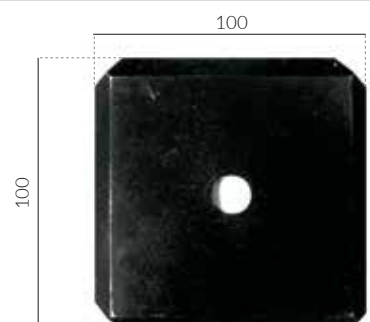

BLADES FOR THE FEED MIXERS

ART. 200 T 182 90 DX - ART. 200 T 182 90 SX

Toothed blade
Holes dimensions:
hole no. 1:12x24 mm
hole no. 2:12x29 mm
Type : right / left
thickness 5,0 mm
weight 0,48 kg.

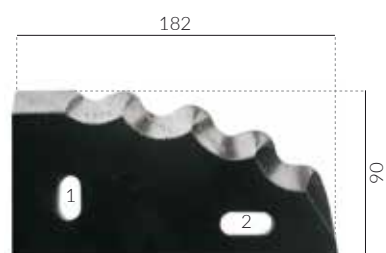

ART. 200 T 190 90 DX - ART. 200 T 190 90 SX

Toothed blade
Holes dimensions:
hole no. 1:11x24 mm
hole no. 2:11x29 mm
Type : right / left
thickness 5,0 mm
weight 0,50 kg.

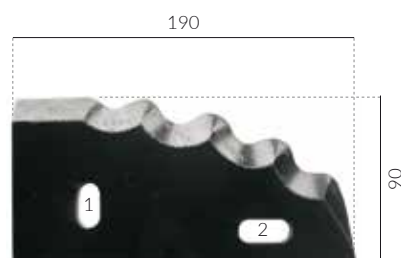

ART. 200 R 190/70

Toothed blade
Square holes 11x11 mm
thickness 5,0 mm
weight 0,38 kg.

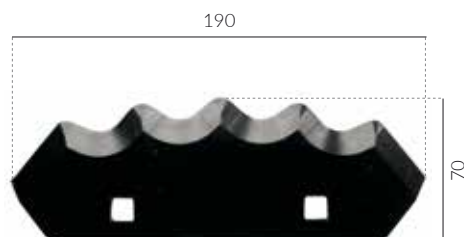

ART. 200 MLF 28

Semicircle sleek blade
Square holes 11x11 mm
thickness 5,0/6,0 mm
weight 0,80 kg.

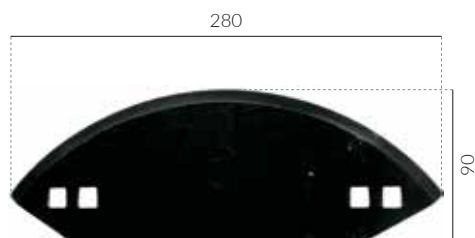

ART. 200 ML 28

Semicircular sleek blade
Square holes 11x11 mm
thickness 5,0 / 6,0 mm
weight 0,93 kg.



ART. 200 R 142/102 DX - ART. 200 R 142/102 SX

Toothed blade
 Type: left / right
 Square holes 11x11 mm
 thickness 5,0 mm
 weight 0,34 kg.

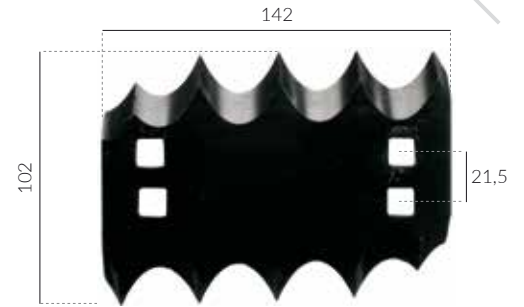

ART. 200 RQ 159 947 DX - ART. 200 RQ 159 947 SX

Toothed blade
 Type: left / right
 Square holes 12x12 mm
 thickness 5,0 mm
 weight 0,38 kg.

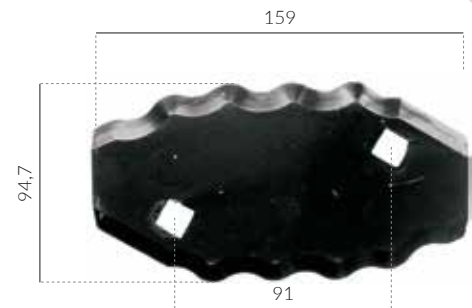

ART. 200 R 159 94 DX - ART. 200 R 159 94 SX

Toothed blade
 Type: left / right
 Square holes $\varnothing 12 \times 8$ mm
 thickness 5,0 mm
 weight 0,38 kg.



ART. 200 RDS 95

SEKO star
 Square hole 11x11 mm
 thickness 5,0 mm
 weight 0,18 kg.

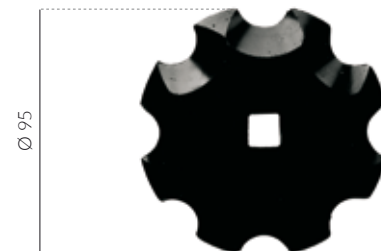

ART. 200 R 205 55

Semicircular sleek blade
 Square holes 12x12 mm
 thickness 5,0 mm
 weight 0,32 kg.



BLADES FOR THE FEED MIXERS

ART. 200 RO 205 55

Semicircular sleek blade
Tearful round hole $\varnothing 12 \times 8$ mm
thickness 5,0 mm
weight 0,32 kg.

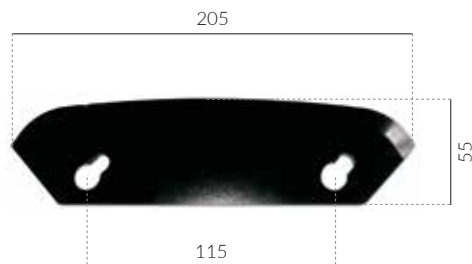

ART. 200 RD 110

Toothed blade
Square hole 11x11 mm
thickness 5,0 / 6,0 mm
weight 0,32 kg.



ART. 200 T 86/31

Sleek blade
Square hole 11x11 mm
thickness 5,0 mm
weight 0,51 kg.

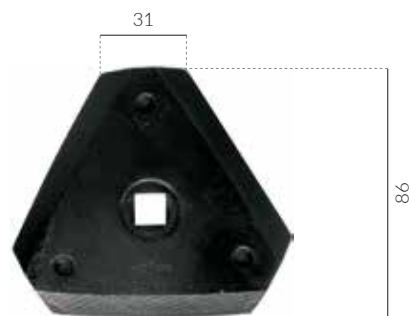

ART. 200 G 190/94

Toothed blade
thickness 5,00 mm
weight 0,50 kg.



ART. 200 T 212 90 DX - ART. 200 T 212 90 SX

Toothed blade, 2 or 3 holes
Holes dimension: 18x13 mm
Type: right / left
thickness 5,0 mm
weight 0,43 kg.

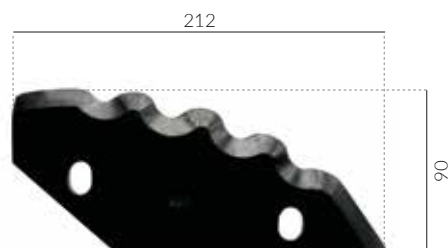

ART. 200 T 160 80 DX - ART. 200 T 160 80 SX

Toothed blade
 Holes dimension: 19x12 mm
 Type: right / left
 thickness 5,0 mm
 weight 0,38 kg.

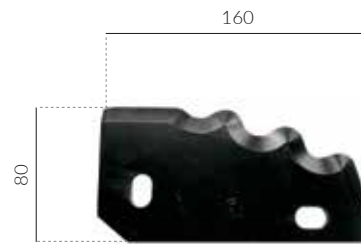

ART. 205 K 254 80

Toothed blade
 Two square holes 20x13 mm
 thickness 6,0 mm
 weight 0,50 kg.

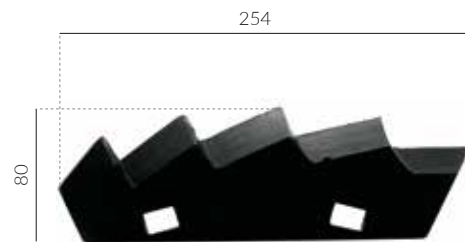

ART. 205 K 240 74

Toothed blade
 Two square holes 20x13 mm
 thickness 6,0 mm
 weight 0,55 kg.

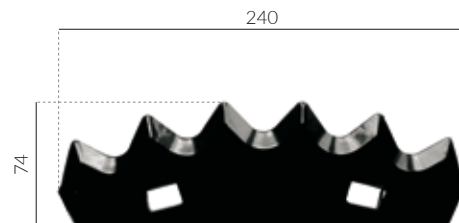

ART. 210 CV 10

Toothed blade for vertical systems
 3 x hole Ø 20,5 mm
 2 x hole Ø 12 mm
 thickness 6,0 mm
 weight 3,25 kg.

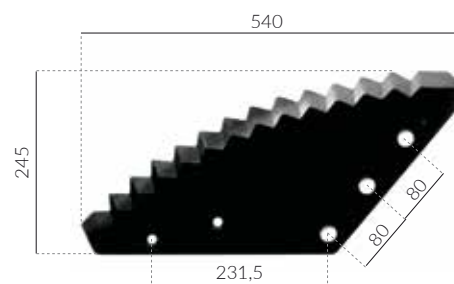

ART. 200 CVS 11

Toothed blade for vertical systems
 thickness 6,0 mm
 weight 3,25 kg.

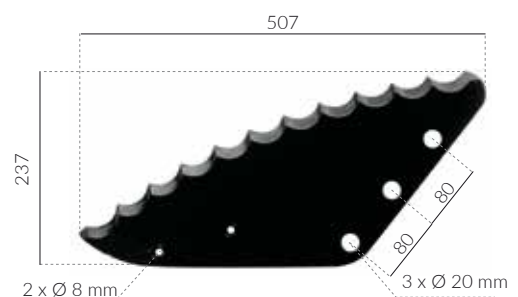

BLADES FOR THE FEED MIXERS

ART. 200 CVS 15

Toothed blade for vertical systems
thickness 6,0 mm
weight 3,25 kg.

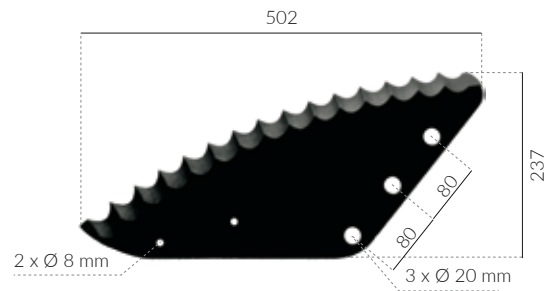

ART. 210 CV 15

Toothed blade for vertical systems
3 x hole Ø 19,5 mm
thickness 6,0 mm
weight 3,25 kg.

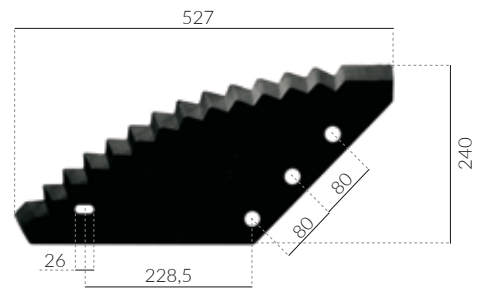

ART. 210 CV 25

Toothed blade for vertical systems
3 x hole Ø 18,5 mm
thickness 5,0 / 6,0 mm
weight 2,60 kg.

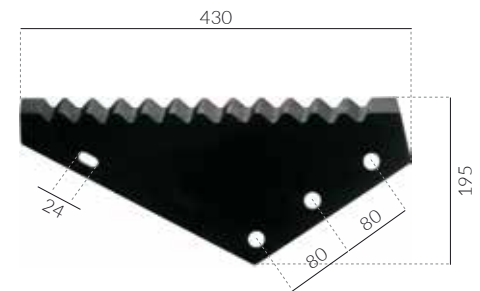

ART. 210 CV 50 DX - ART. 210 CV 51 SX

Toothed blade for vertical systems
thickness 6,0 mm
weight 3,25 kg.

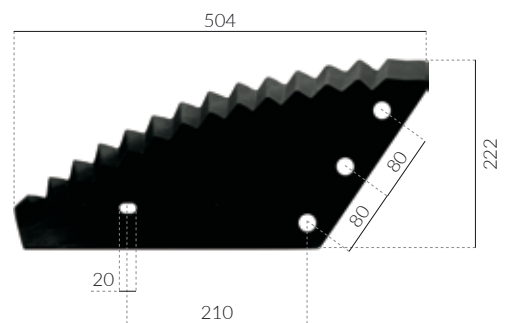

ART. 210 CV 70

Toothed blade for vertical systems
thickness 6,0 mm
weight 3,25 kg.

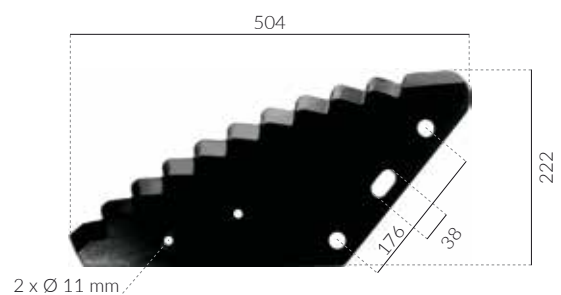

ART. 200 CVK 80

Toothed blade for vertical systems
thickness 8,0 mm
weight 4,20 kg.

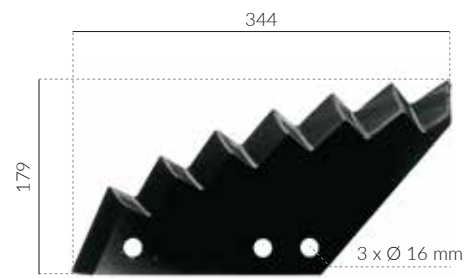

ART. 220 CVW

weight 1,46 kg.



ART. 220 CVM

weight 1,10 kg.

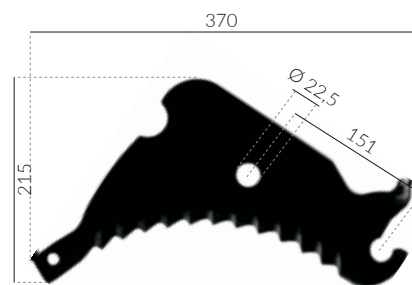

ART. 220 CVC

weight 1,35 kg.



BLADES FOR THE FEED MIXERS

ART. 220 CV DF

weight 2,00 kg.



ART. 220 CV FEL

weight 2,49 kg.

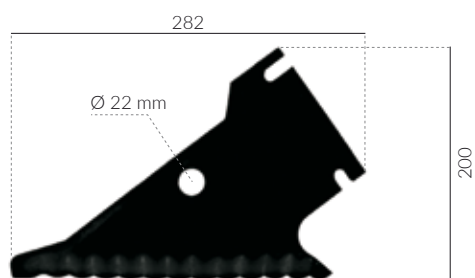

ART. 220 CV KRO

weight 2,70 kg.

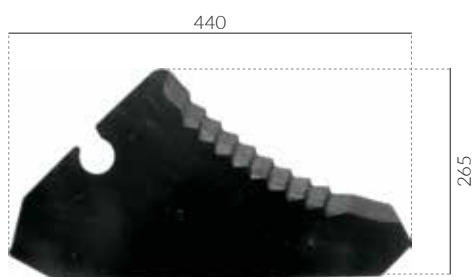

ART. 220 CV CLA

weight 1,62 kg.

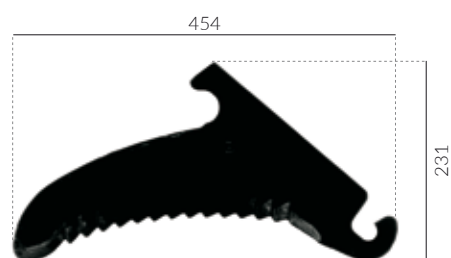



Ploughs Parts
Boron Steel
Triplex Steel





HOW TO REACH

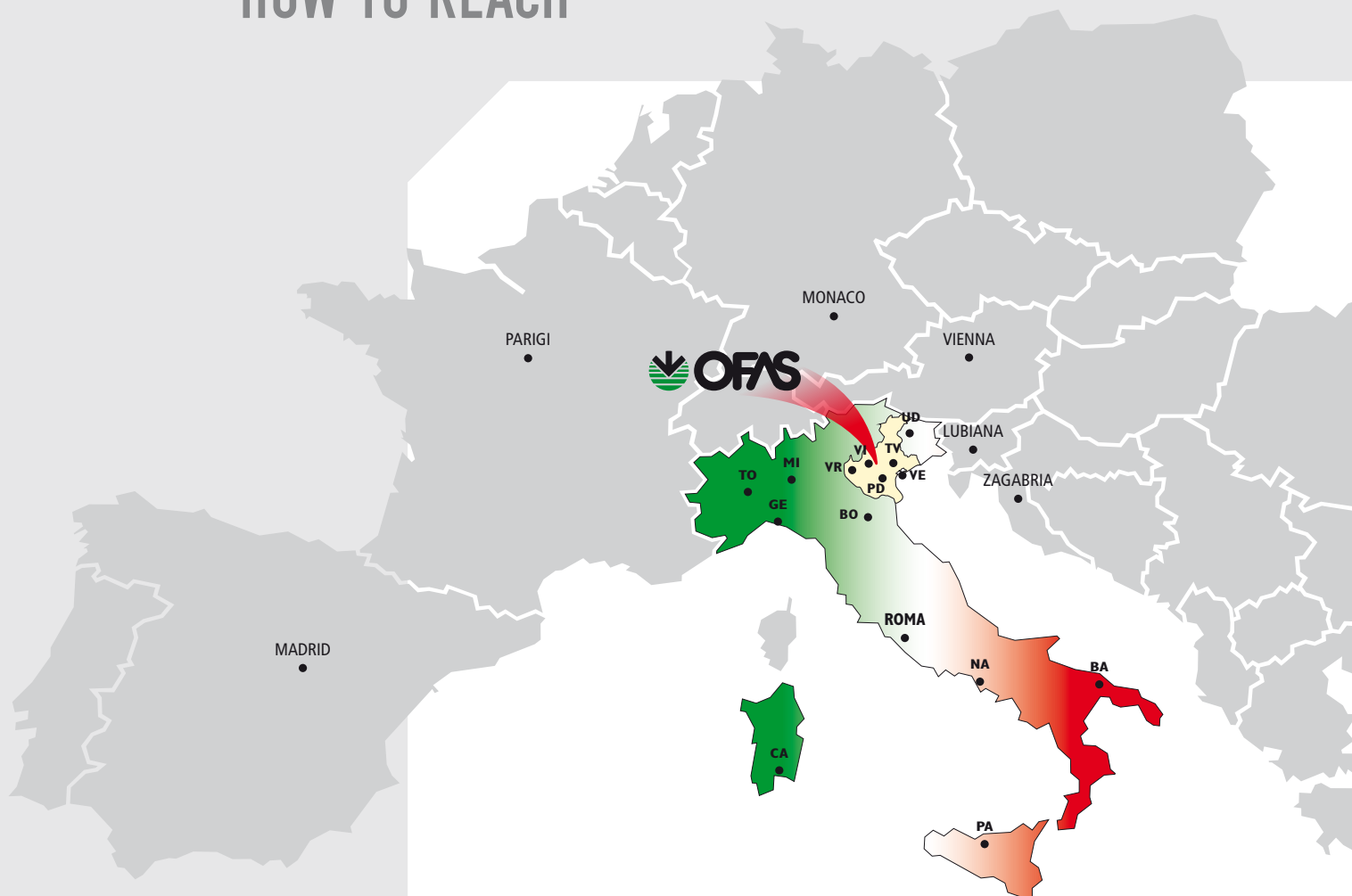

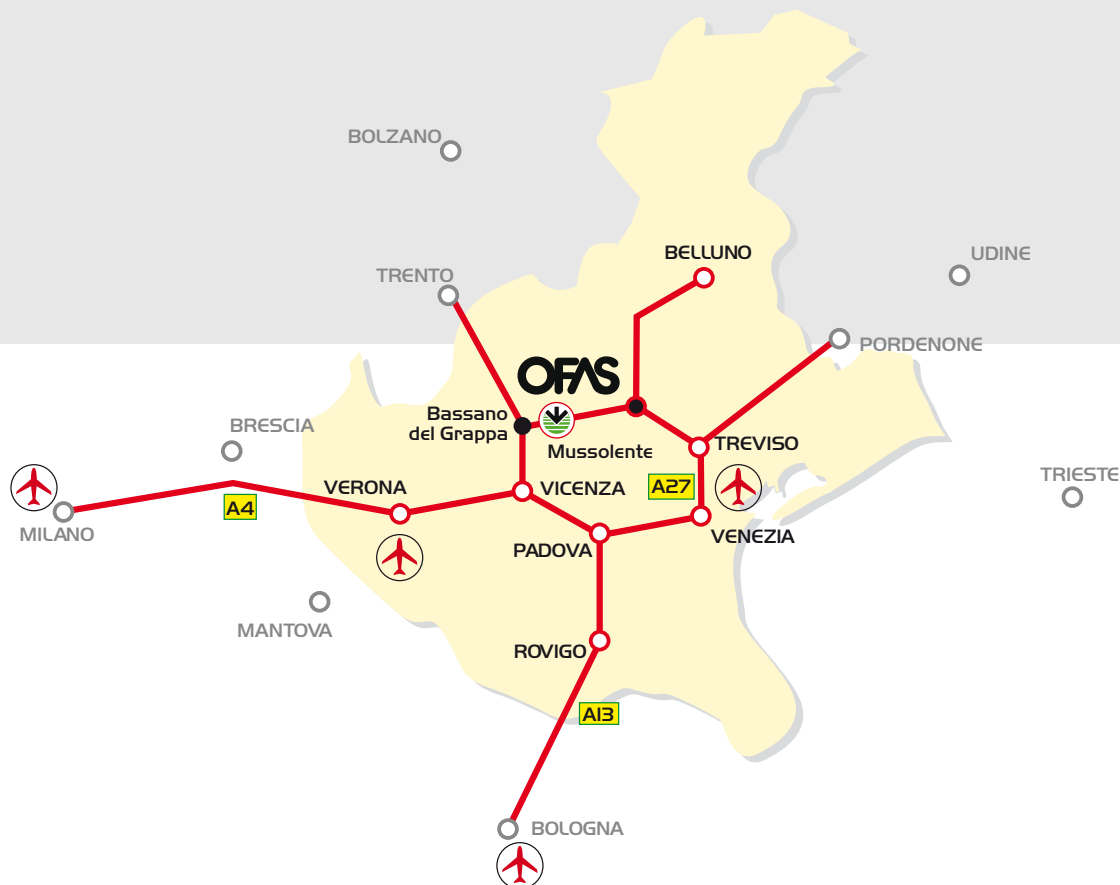

From MILANO: Highway Serenissima (A4) in Vicenza take highway Valdastico exit Dueville. Arterial road SS. 248 to Marostica expressway to Trento exit Bassano Est, follow the directions.

From BOLOGNA: Highway (A13) exit Padova - Limena. Arterial road SS. 47 to Cittadella - Bassano. Arterial road SS. 248 to Mussolente-Asolo, Montebelluna.

From VENEZIA: Arterial road SS. 13 to Treviso. Arterial road SS. 248 to Montebelluna - Asolo - Mussolente.

From TRENTO: Expressway to Bassano del Grappa. Exit Bassano Est, follow the directions.

AIRPORT: Venezia - Marco Polo, 60 Km. Treviso - S. Giuseppe, 30 Km. Verona Villafranca, 100 Km.





O.F.A.S spa

Via Dante Alighieri, 25
36065 Mussolente (VI) - Italy
T + 39 0424 577 222
F + 39 0424 577 159
www.ofas.it - info@ofas.it

Edition n. 11